

# TIGARD BUSINESS PARK

11844 SW PACIFIC HWY • TIGARD, OR 97223



- 7-building industrial business center
- Conveniently located next to Oregon Route 217, Oregon Route 99W, and near I-5
- 259,124 Square Feet

## Property Summary

|                      |                |
|----------------------|----------------|
| <b>AVAILABLE SF</b>  | 4,138-8,005 SF |
| <b>BUILDING SIZE</b> | 259,124 SF     |
| <b>MARKET</b>        | Portland       |

**For more information, please contact:**

### **NICCOLINA MERLINO**

LEASING MANAGER  
BKM MANAGEMENT  
P. 206.487.7044  
E. [NMERLINO@BKMMGMT.COM](mailto:NMERLINO@BKMMGMT.COM)

### **NICCOLINA MERLINO**

LEASING SPECIALIST  
BKM MANAGEMENT COMPANY  
P. 206.487.7044  
E. [NMERLINO@BKMMGMT.COM](mailto:NMERLINO@BKMMGMT.COM)

# TIGARD BUSINESS PARK

11844 SW PACIFIC HWY • TIGARD, OR 97223



**LEGEND**

- ▲ DOCK HIGH DOORS
- GRADE LEVEL DOORS

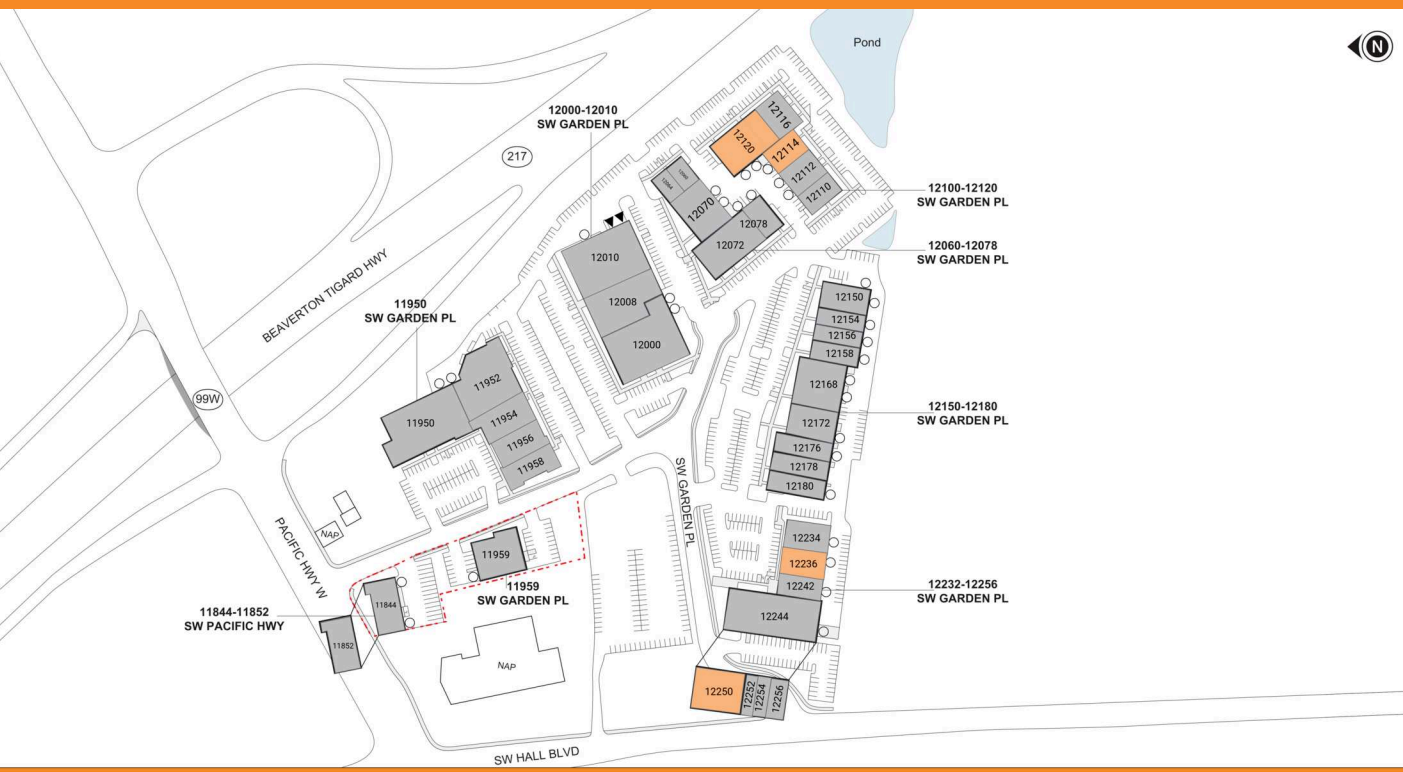

■ AVAILABLE ■ OCCUPIED

## Current Availabilities

| BUILDING | SUITE | TOTAL SIZE | OFFICE SIZE | OFFICE % | TYPE | CLEAR HT | GL | DL |
|----------|-------|------------|-------------|----------|------|----------|----|----|
| 4        | 12114 | 4,138      | 2,069       | 50       | IND  | 15       | 1  | 0  |
| 4        | 12120 | 8,005      | 1,958       | 24       | IND  | 12       | 1  | 0  |
| 1        | 12236 | 5,106      | 2,659       | 52       | IND  | 9        | 2  | 0  |
| 1        | 12250 | 6,800      | 6,800       | 100      | OFF  | 0        | 0  | 0  |

# TIGARD BUSINESS PARK

11844 SW PACIFIC HWY • TIGARD, OR 97223



# TIGARD BUSINESS PARK

11844 SW PACIFIC HWY • TIGARD, OR 97223

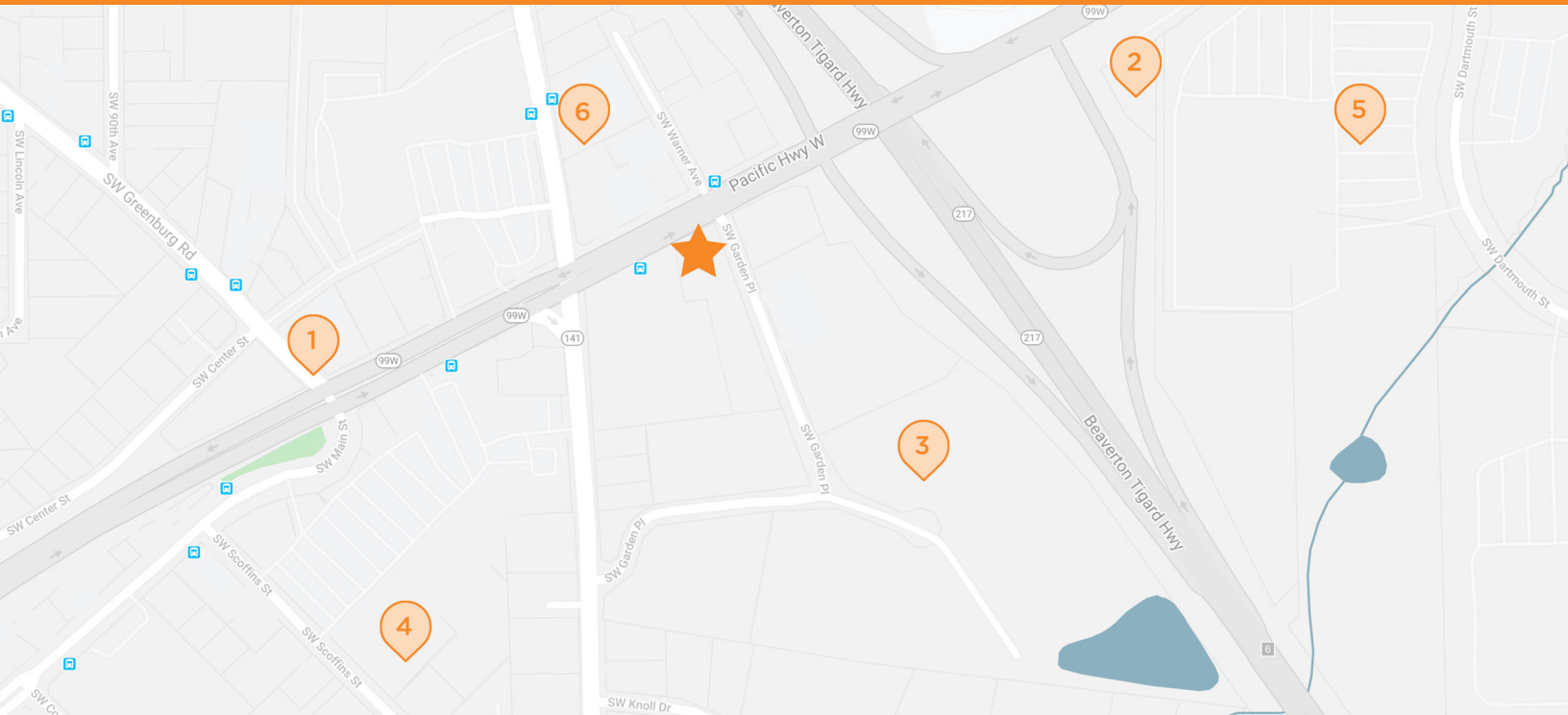

## TIGARD BUSINESS PARK

11844-11852 SW Pacific Hwy.; 11950-12256 SW Garden Pl., Tigard, OR 97223



**BANK OF AMERICA**  
11999 SW Pacific Hwy  
Tigard, OR



**DUTCH BROS COFFEE**  
11744 SW Pacific Hwy  
Tigard, OR



**SKYHOOK NINJA FITNESS**  
12008 SW Garden Pl  
Tigard, OR



**RITE AID PHARMACY**  
12080 SW Main St  
Tigard, OR



**COSTCO**  
7850 SW Dartmouth St  
Tigard, OR



**WELLS FARGO BANK**  
11760 SW Hall Blvd  
Tigard, OR