

TIGARD BUSINESS PARK

11844 SW PACIFIC HWY • TIGARD, OR 97223



- 7-building industrial business center
- Conveniently located next to Oregon Route 217, Oregon Route 99W, and near I-5
- 259,124 Square Feet

Property Summary

AVAILABLE SF	4,138-8,005 SF
BUILDING SIZE	259,124 SF
RENOVATED	2024
MARKET	Portland

For more information, please contact:

NICCOLINA MERLINO

LEASING MANAGER

BKM MANAGEMENT

P. 206.487.7044

E. NMERLINO@BKMMGMT.COM

TIGARD BUSINESS PARK

11844 SW PACIFIC HWY • TIGARD, OR 97223



LEGEND

- ▲ DOCK HIGH DOORS
- GRADE LEVEL DOORS

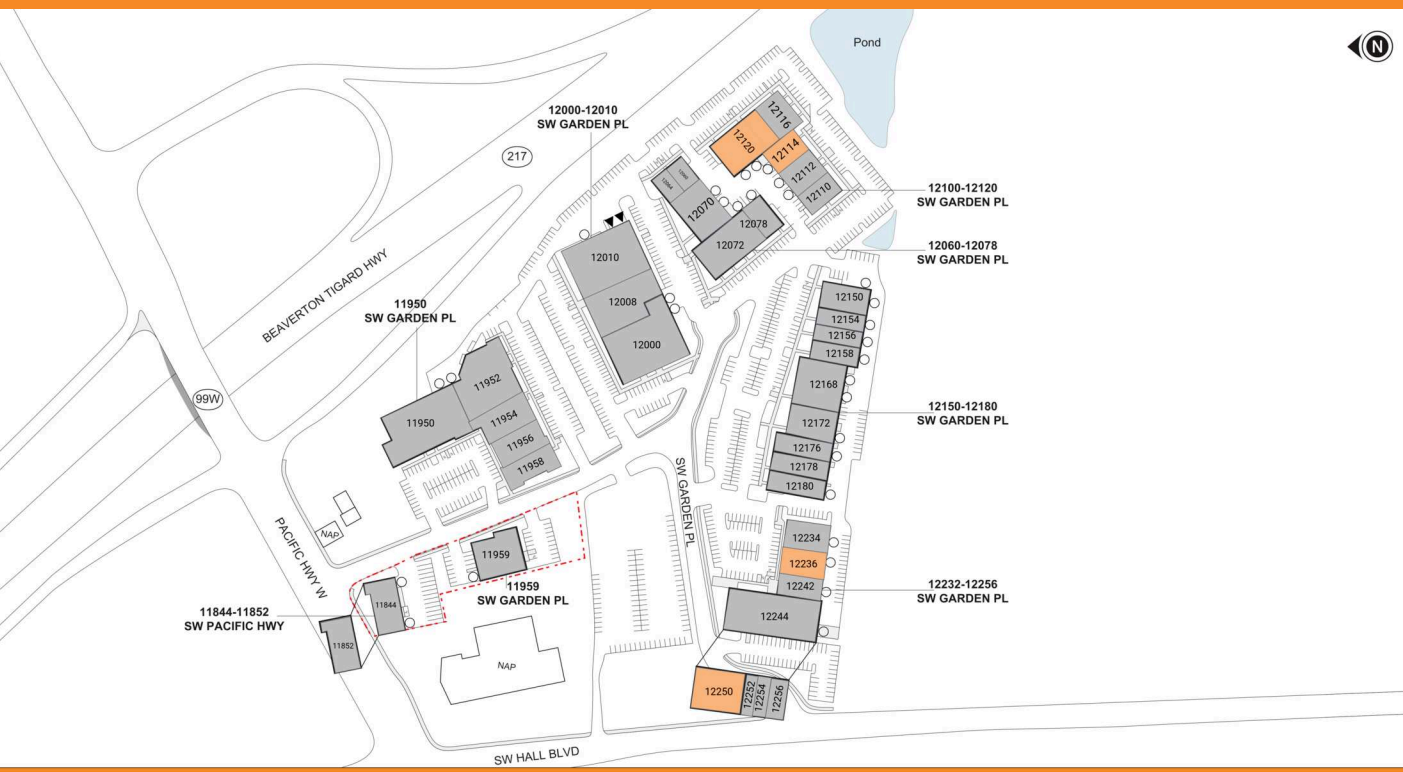

■ AVAILABLE ■ OCCUPIED

Current Availabilities

BUILDING	SUITE	TOTAL SIZE	OFFICE SIZE	OFFICE %	TYPE	CLEAR HT	GL	DL
4	12114	4,138	2,069	50	IND	15	1	0
4	12120	8,005	1,958	24	IND	12	1	0
1	12236	5,106	2,659	52	IND	9	2	0
1	12250	6,800	6,800	100	OFF	0	0	0

TIGARD BUSINESS PARK

11844 SW PACIFIC HWY • TIGARD, OR 97223



TIGARD BUSINESS PARK

11844 SW PACIFIC HWY • TIGARD, OR 97223

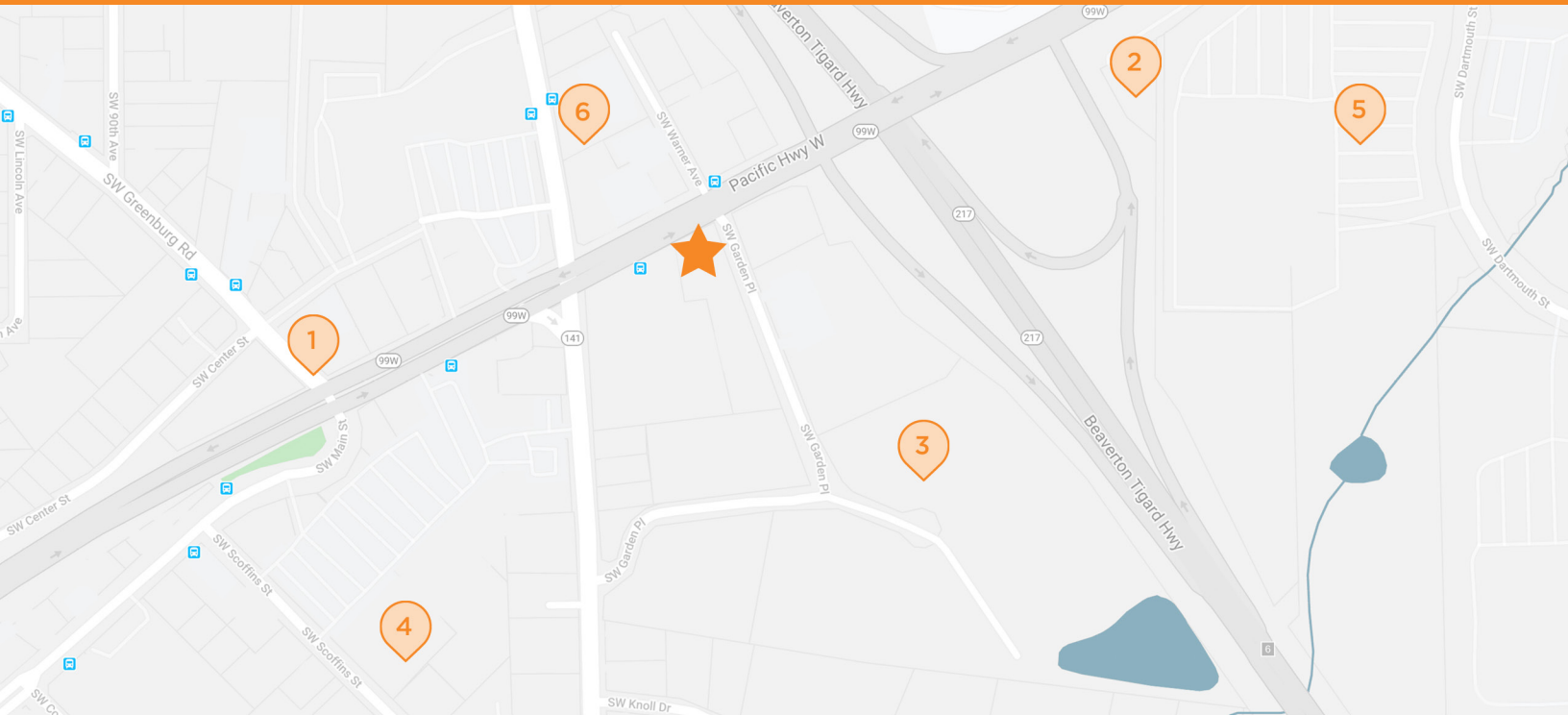

TIGARD BUSINESS PARK

11844-11852 SW Pacific Hwy.; 11950-12256 SW Garden Pl., Tigard, OR 97223



BANK OF AMERICA
11999 SW Pacific Hwy
Tigard, OR



DUTCH BROS COFFEE
11744 SW Pacific Hwy
Tigard, OR



SKYHOOK NINJA FITNESS
12008 SW Garden Pl
Tigard, OR



RITE AID PHARMACY
12080 SW Main St
Tigard, OR



COSTCO
7850 SW Dartmouth St
Tigard, OR



WELLS FARGO BANK
11760 SW Hall Blvd
Tigard, OR