

# TIGARD BUSINESS PARK

11844 SW PACIFIC HWY • TIGARD, OR 97223



- 7-building industrial business center
- Conveniently located next to Oregon Route 217, Oregon Route 99W, and near I-5
- 259,124 Square Feet

## Property Summary

AVAILABLE SF	4,138-8,005 SF
BUILDING SIZE	259,124 SF
RENOVATED	2024
MARKET	Portland

For more information, please contact:

**NICCOLINA MERLINO**

LEASING MANAGER

BKM MANAGEMENT

P. 206.487.7044

E. [NMERLINO@BKMMGMT.COM](mailto:NMERLINO@BKMMGMT.COM)

# TIGARD BUSINESS PARK

11844 SW PACIFIC HWY • TIGARD, OR 97223



**LEGEND**

- ▲ DOCK HIGH DOORS
- GRADE LEVEL DOORS

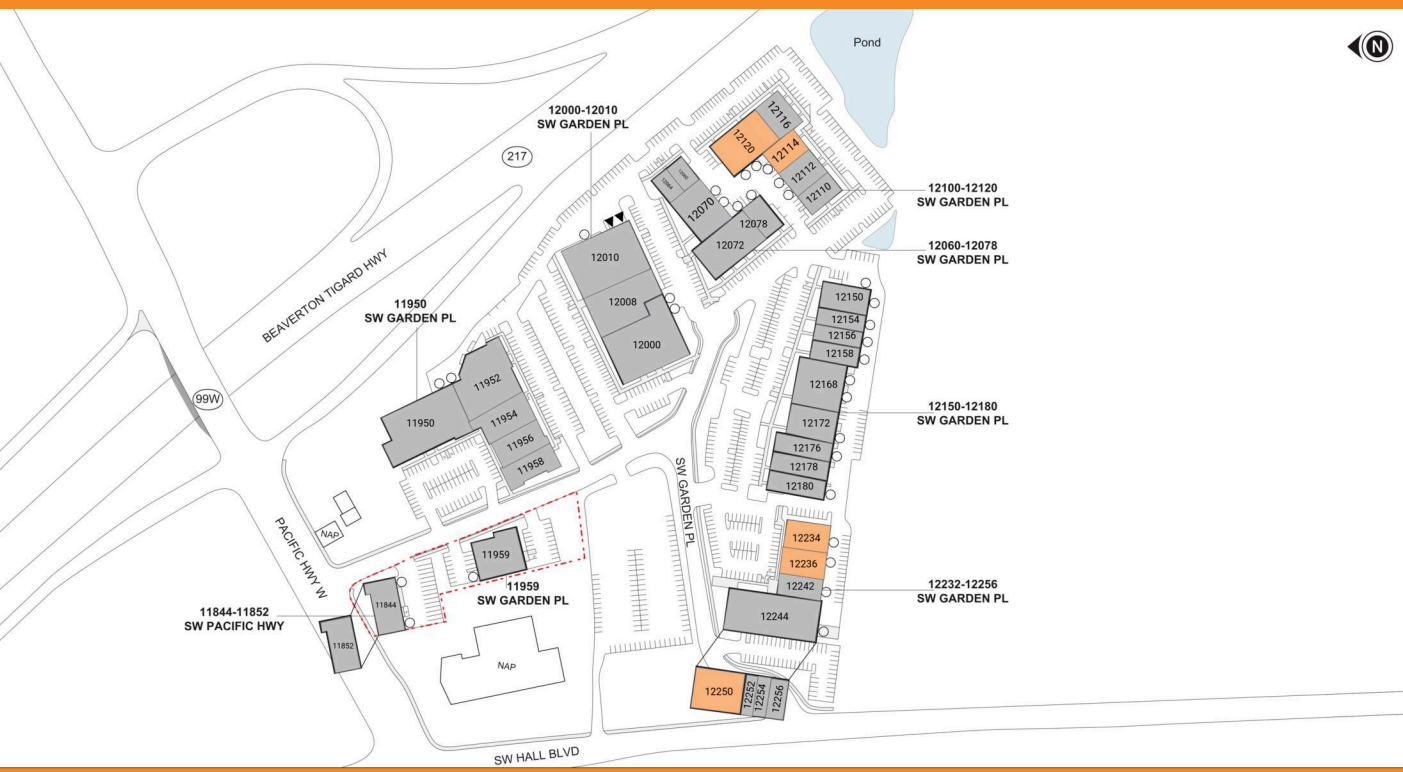

■ AVAILABLE ■ OCCUPIED

## Current Availabilities

BUILDING	SUITE	TOTAL SIZE	OFFICE SIZE	OFFICE %	TYPE	CLEAR HT	GL	DL
4	12114	4,138	2,069	50	IND	15	1	0
4	12120	8,005	1,958	24	IND	12	1	0
1	12234	5,428	2,194	40	IND	15	1	0
1	12236	5,106	2,659	52	IND	9	2	0
1	12250	6,800	6,800	100	OFF	0	0	0

# TIGARD BUSINESS PARK

11844 SW PACIFIC HWY • TIGARD, OR 97223



# TIGARD BUSINESS PARK

11844 SW PACIFIC HWY • TIGARD, OR 97223

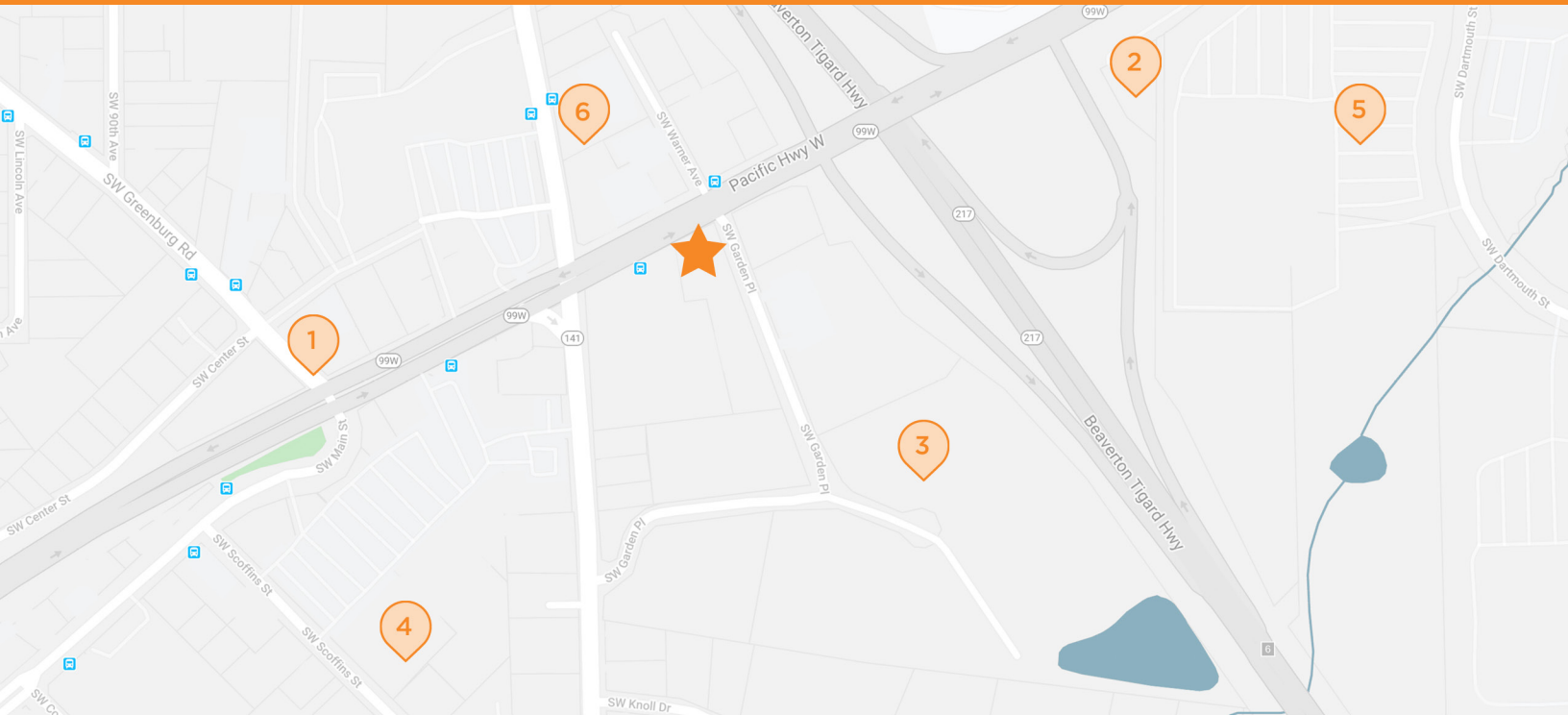

## TIGARD BUSINESS PARK

11844-11852 SW Pacific Hwy.; 11950-12256 SW Garden Pl., Tigard, OR 97223



**BANK OF AMERICA**  
11999 SW Pacific Hwy  
Tigard, OR



**DUTCH BROS COFFEE**  
11744 SW Pacific Hwy  
Tigard, OR



**SKYHOOK NINJA FITNESS**  
12008 SW Garden Pl  
Tigard, OR



**RITE AID PHARMACY**  
12080 SW Main St  
Tigard, OR



**COSTCO**  
7850 SW Dartmouth St  
Tigard, OR



**WELLS FARGO BANK**  
11760 SW Hall Blvd  
Tigard, OR