

BUTTES BUSINESS PARK

2105 - 2231 S. 48TH • TEMPE, AZ 85282



- 188,282 SF across 13 buildings in a highly visible Tempe location.
- Positioned near I-10, Loop 202, and Phoenix Sky Harbor International Airport for regional access.
- Wide range of suite sizes supports office, showroom, and light industrial tenants.
- Features 68 grade-level doors, ample parking, and strong curb appeal for tenant branding.

Property Summary

AVAILABLE SF	600-2,550 SF
BUILDING SIZE	184,006 SF
MARKET	Tempe

For more information, please contact:

RICKY BORANE
LEASING MANAGER
BKM MANAGEMENT COMPANY
P. 602.362.0803
E. RBORANE@BKMMGMT.COM

BUTTES BUSINESS PARK

2105 - 2231 S. 48TH • TEMPE, AZ 85282

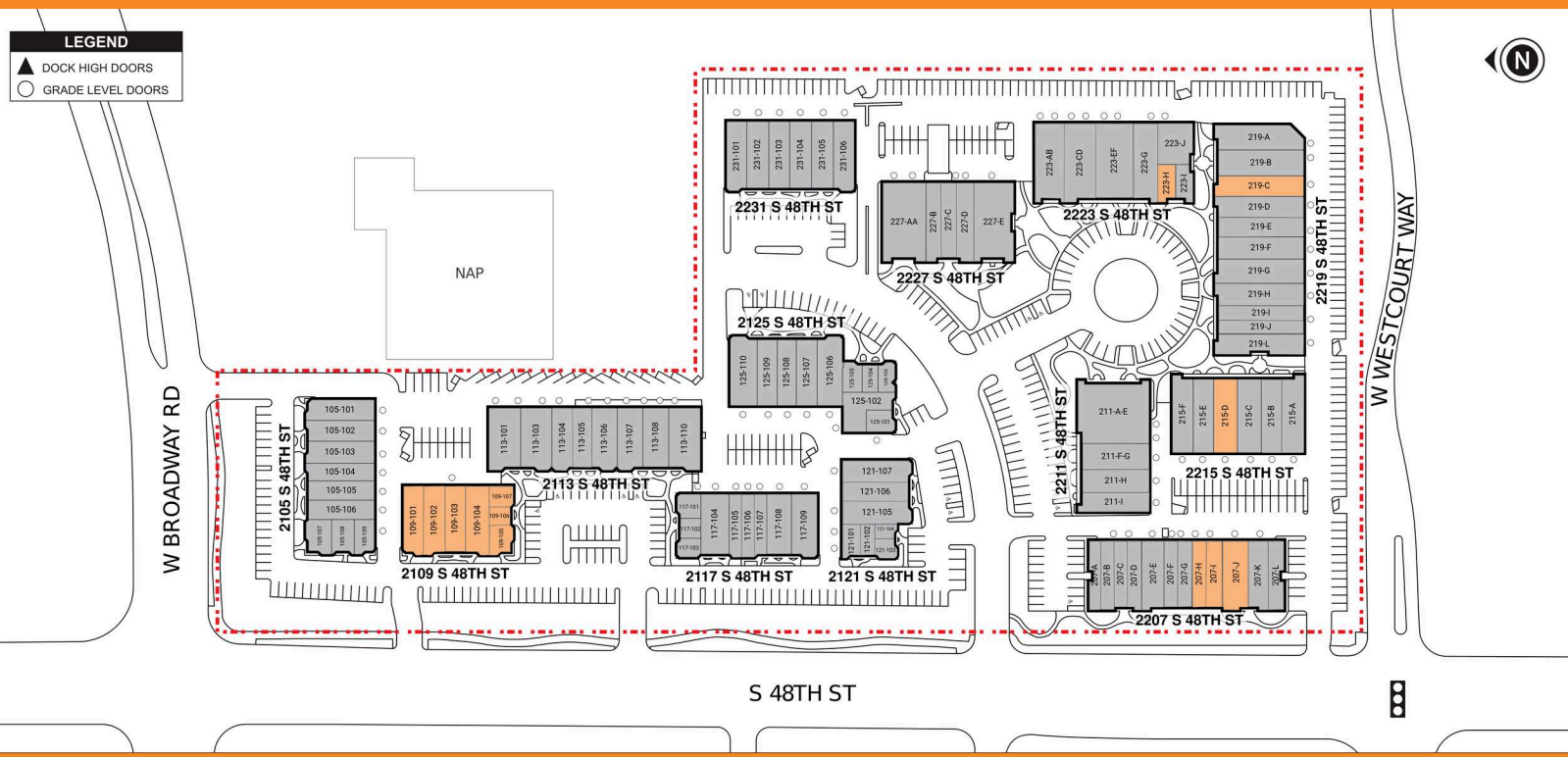

■ AVAILABLE ■ OCCUPIED

Current Availabilities

BUILDING	SUITE	TOTAL SIZE	OFFICE SIZE	OFFICE %	TYPE	CLEAR HT	GL	DL
N/A	109-101	1,920	0	0	N/A	N/A	N/A	
N/A	109-102	1,920	0	0	N/A	N/A	N/A	
N/A	109-103	1,920	0	0	N/A	N/A	N/A	
N/A	109-104	1,920	0	0	N/A	N/A	N/A	
N/A	109-105	1,080	0	0	N/A	N/A	N/A	
N/A	109-106	600	0	0	N/A	N/A	N/A	
N/A	109-107	720	0	0	N/A	N/A	N/A	
N/A	207-H	1,640	0	0	N/A	N/A	N/A	
N/A	207-I	1,640	0	0	N/A	N/A	N/A	
N/A	207-J	1,640	0	0	N/A	N/A	N/A	
N/A	215-D	2,250	0	0	N/A	N/A	N/A	
N/A	219-C	2,550	0	0	N/A	N/A	N/A	
N/A	223-H	900	0	0	N/A	N/A	N/A	

BUTTES BUSINESS PARK

2105 - 2231 S. 48TH • TEMPE, AZ 85282



BUTTES BUSINESS PARK

2105 - 2231 S. 48TH • TEMPE, AZ 85282

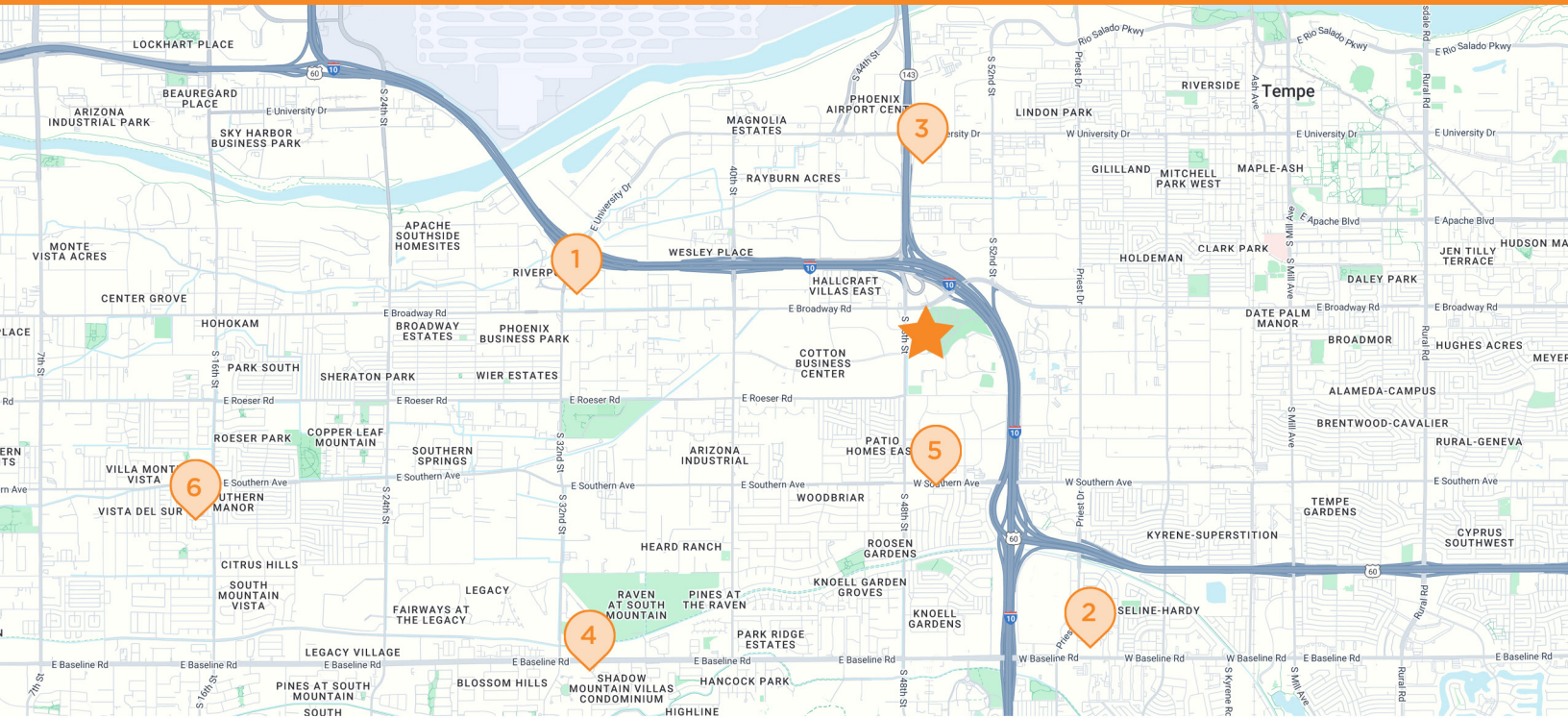

BUTTES BUSINESS PARK

2105 - 2231 S. 48th, Tempe, AZ 85282

1

ARCO

1725 Arnold Industrial Pl
Concord, CA

2

HAMPTON INN

1785 Pine St
Concord, CA

3

SAFEWAY

2600 Willow Pass Rd
Concord, CA

4

COSTCO WHOLESALE

2400 Monument Blvd
Concord, CA

5

STARBUCKS

3373 Port Chicago Hwy
Concord, CA

6

CHASE BANK

2097 Salvio St
Concord, CA