

# BUTTES BUSINESS PARK

2105 - 2231 S. 48TH • TEMPE, AZ 85282



- 188,282 SF across 13 buildings in a highly visible Tempe location.
- Positioned near I-10, Loop 202, and Phoenix Sky Harbor International Airport for regional access.
- Wide range of suite sizes supports office, showroom, and light industrial tenants.
- Features 68 grade-level doors, ample parking, and strong curb appeal for tenant branding.

## Property Summary

AVAILABLE SF	800-2,860 SF
BUILDING SIZE	181,691 SF
MARKET	Tempe

For more information, please contact:

**CHAD TORRES**  
LEASING MANAGER  
P. 602-325-8492  
E. CTORRES@BKMMGMT.COM

# BUTTES BUSINESS PARK

2105 - 2231 S. 48TH • TEMPE, AZ 85282

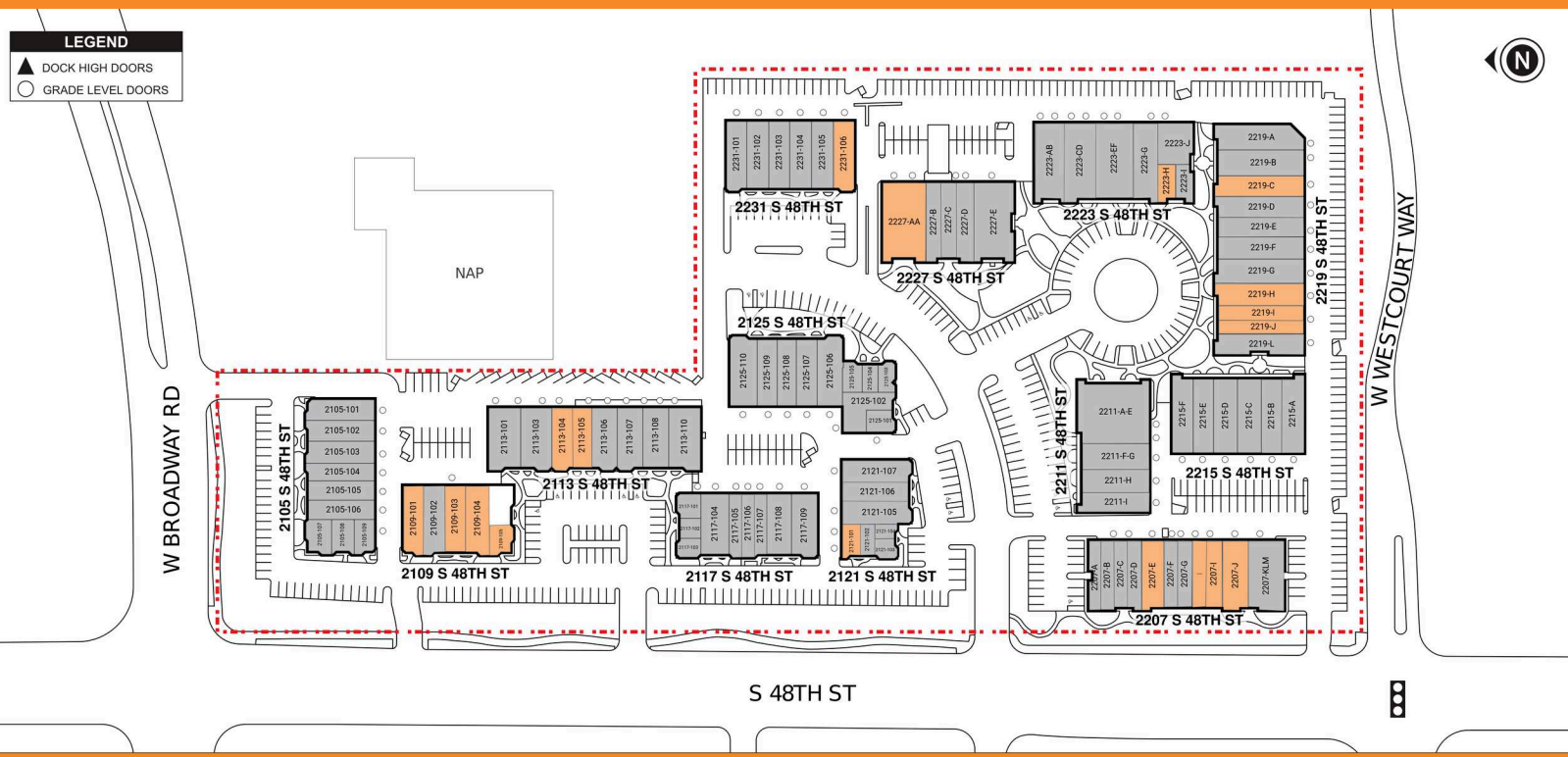

■ AVAILABLE ■ OCCUPIED

## Current Availabilities

BUILDING	SUITE	TOTAL SIZE	OFFICE SIZE	OFFICE %	TYPE	CLEAR HT	GL	DL
N/A	2109-101	1,920	545	28	N/A	1	0	
N/A	2109-103	1,920	802	38	N/A	1	0	
N/A	2109-104	1,920	605	31	N/A	1	0	
N/A	2109-105	1,080	1,113	45	N/A	0	0	
N/A	2113-104	1,728	2,777	80	N/A	1	0	
N/A	2113-105	1,728	2,777	80	N/A	1	0	
N/A	2121-101	800	1,593	76	N/A	1	0	
N/A	2207-E	1,640	1,035	63	N/A	1	0	
2207-H								
N/A	2207-I	1,640	1,135	34	N/A	2	0	
N/A	2207-J	1,640	507	31	N/A	1	0	
N/A	2219-C	2,550	1,000	38	N/A	1	0	
N/A	2219-H	2,550	1,638	64	N/A	1	0	
N/A	2219-I	1,530	0	0	N/A	1	0	
N/A	2219-J	2,550	0	0	N/A	1	0	
N/A	2223-H	900	910	100	N/A	0	0	
N/A	2227-AA	2,860	1,449	51	N/A	1	0	

# BUTTES BUSINESS PARK

2105 - 2231 S. 48TH • TEMPE, AZ 85282

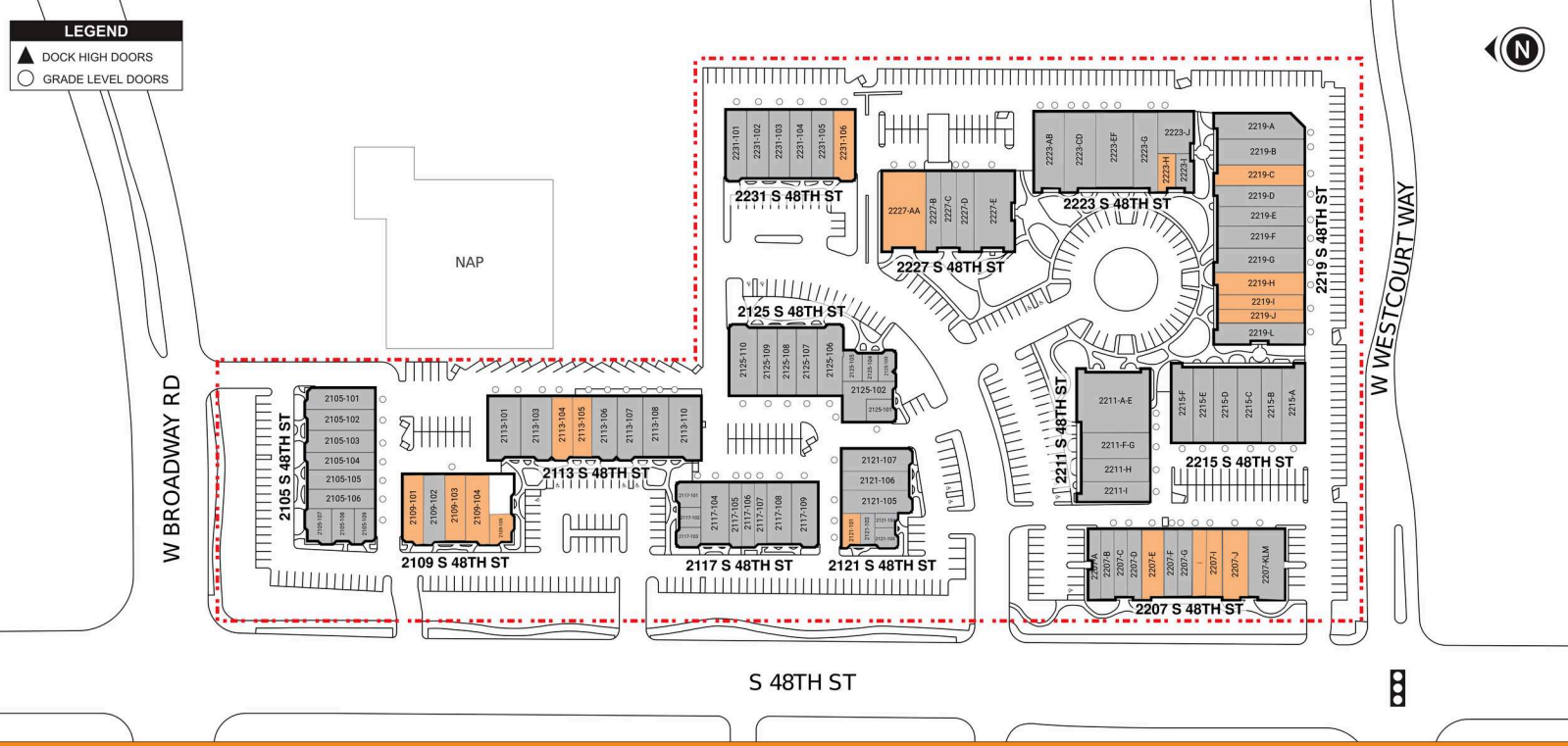

■ AVAILABLE    ■ OCCUPIED

## Current Availabilities

BUILDING	SUITE	TOTAL SIZE	OFFICE SIZE	OFFICE %	TYPE	CLEAR HT	GL	DL
N/A	2231-106	2,000	398	20	N/A	1	0	

# BUTTES BUSINESS PARK

2105 - 2231 S. 48TH • TEMPE, AZ 85282



# BUTTES BUSINESS PARK

2105 - 2231 S. 48TH • TEMPE, AZ 85282

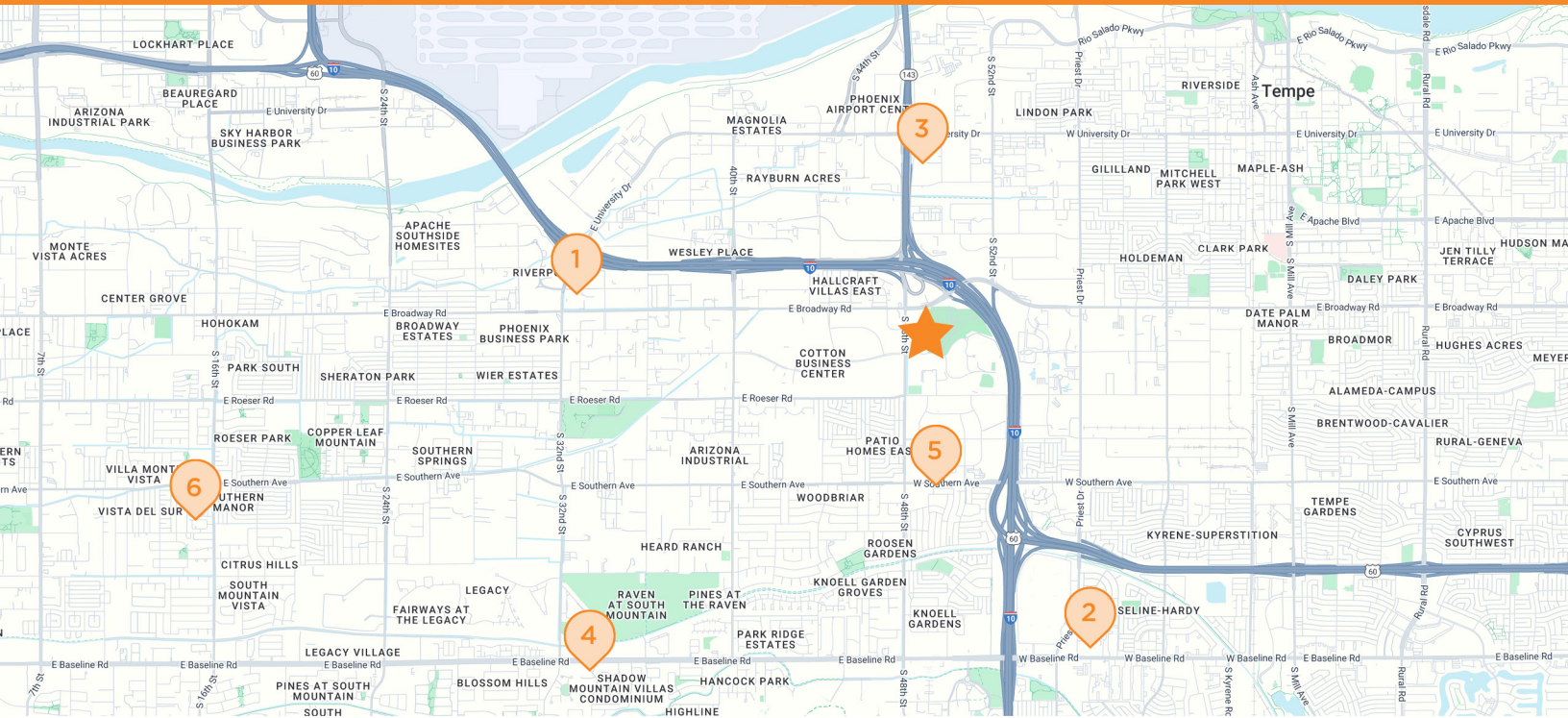

## BUTTES BUSINESS PARK

2105 - 2231 S. 48th, Tempe, AZ 85282

- 1 ARCO**  
1725 Arnold Industrial Pl  
Concord, CA
- 2 HAMPTON INN**  
1785 Pine St  
Concord, CA
- 3 SAFEWAY**  
2600 Willow Pass Rd  
Concord, CA
- 4 COSTCO WHOLESALE**  
2400 Monument Blvd  
Concord, CA
- 5 STARBUCKS**  
3373 Port Chicago Hwy  
Concord, CA
- 6 CHASE BANK**  
2097 Salvio St  
Concord, CA