

# EXPRESSWAY CORPORATE CENTER

3015, 3101-3131 S. PARK DR., 3010, 3110 AND 3120 S. POTTER DR., 2307 & 2315 W. FAIRMONT DR. • TEMPE, AZ 85282



- 79,333 SF across ten buildings and 20' clear heights.
- Prime Tempe location near I-10 and US-60, minutes from Phoenix Sky Harbor International Airport.
- Ample parking and modern TPO roofing for long-term operational reliability.

## Property Summary

AVAILABLE SF	7,072-7,072 SF
BUILDING SIZE	76,891 SF
RENOVATED	2025
MARKET	Tempe

For more information, please contact:

### RICKY BORANE

LEASING MANAGER

BKM MANAGEMENT COMPANY

P. 602.362.0803

E. RBORANE@BKMMGMT.COM

# EXPRESSWAY CORPORATE CENTER

3015, 3101-3131 S. PARK DR., 3010, 3110 AND 3120 S. POTTER DR., 2307 & 2315 W. FAIRMONT DR. • TEMPE, AZ 85282



**LEGEND**

- ▲ DOCK HIGH DOORS
- GRADE LEVEL DOORS

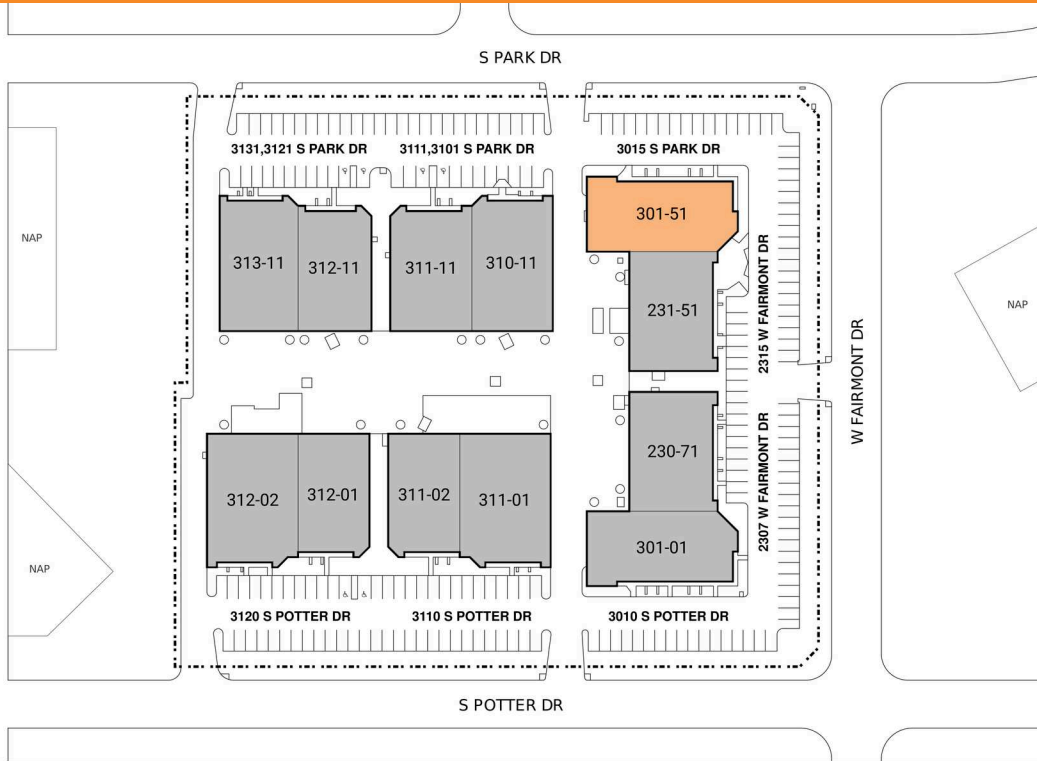

■ AVAILABLE   ■ OCCUPIED

## Current Availabilities

BUILDING	SUITE	TOTAL SIZE	OFFICE SIZE	OFFICE %	TYPE	CLEAR HT	GL	DL
N/A	301-51	7,072	0	0	N/A	1	0	

# EXPRESSWAY CORPORATE CENTER

3015, 3101-3131 S. PARK DR., 3010, 3110 AND 3120 S. POTTER DR., 2307 & 2315 W. FAIRMONT DR. •  
TEMPE, AZ 85282



# EXPRESSWAY CORPORATE CENTER

3015, 3101-3131 S. PARK DR., 3010, 3110 AND 3120 S. POTTER DR., 2307 & 2315 W. FAIRMONT DR. • TEMPE, AZ 85282

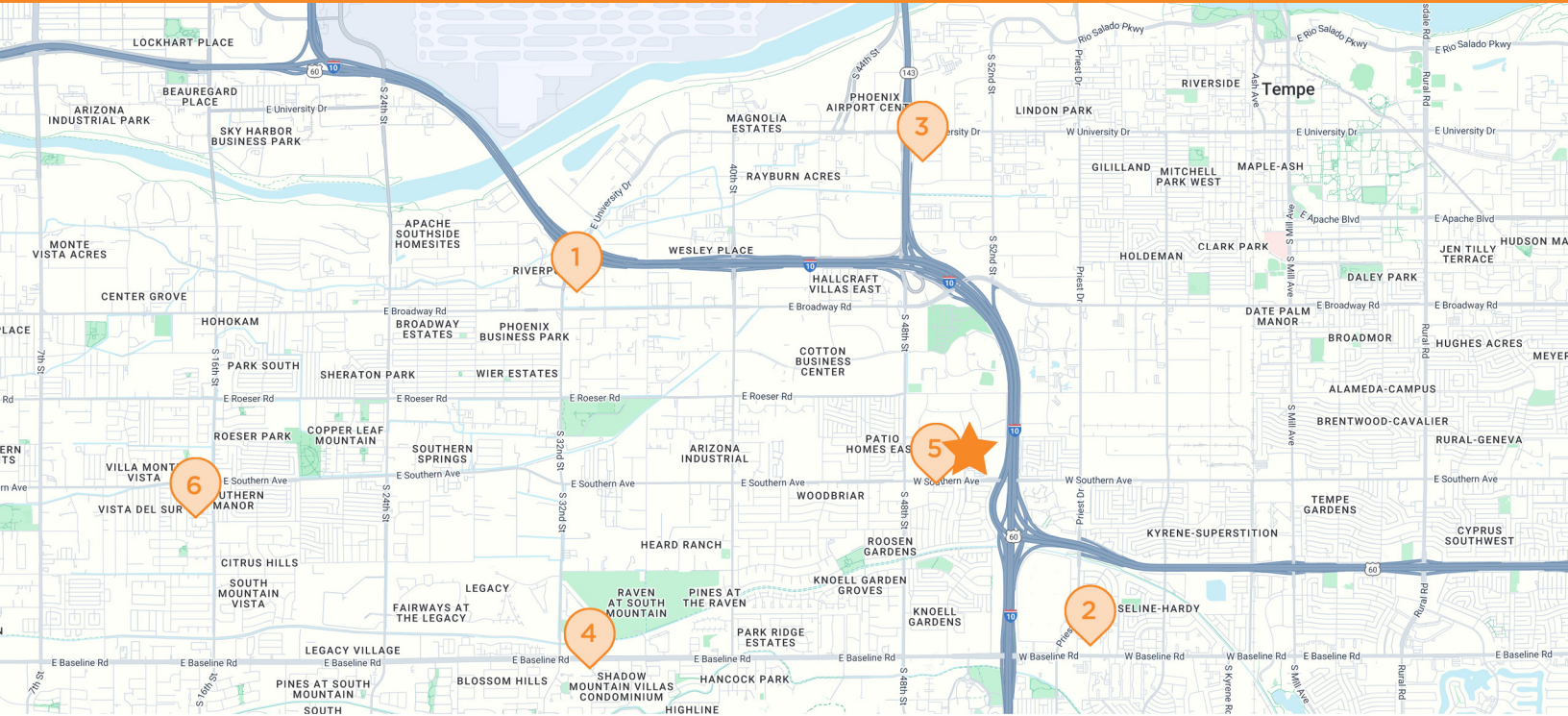

 **EXPRESSWAY CORPORATE CENTER**  
3015, 3101-3131 S. Park Dr., 3010, 3110 and 3120 S. Potter Dr., 2307 & 2315 W. Fairmont Dr., Tempe, AZ 85282

**1 ARCO**  
1725 Arnold Industrial Pl  
Concord, CA

**2 HAMPTON INN**  
1785 Pine St  
Concord, CA

**3 SAFEWAY**  
2600 Willow Pass Rd  
Concord, CA

**4 COSTCO WHOLESALE**  
2400 Monument Blvd  
Concord, CA

**5 STARBUCKS**  
3373 Port Chicago Hwy  
Concord, CA

**6 CHASE BANK**  
2097 Salvio St  
Concord, CA