

HOOVER BUSINESS PARK

12661 HOOVER STREET • STANTON, CA 90680



- Small-bay industrial park within central Orange County
- Warehouse suites with grade-level loading and office buildouts
- Efficient layouts designed to support operational flexibility

Property Summary

AVAILABLE SF	521-3,600 SF
BUILDING SIZE	157,985 SF
RENOVATED	2022
MARKET	Orange County

For more information, please contact:

LORI MCAMIS
LEASING MANAGER
BKM MANAGEMENT COMPANY
P. 949.335.5826
E. LMCAMIS@BKMMGMT.COM

HOOVER BUSINESS PARK

12661 HOOVER STREET • STANTON, CA 90680



LEGEND

- ▲ DOCK HIGH DOORS
- GRADE LEVEL DOORS

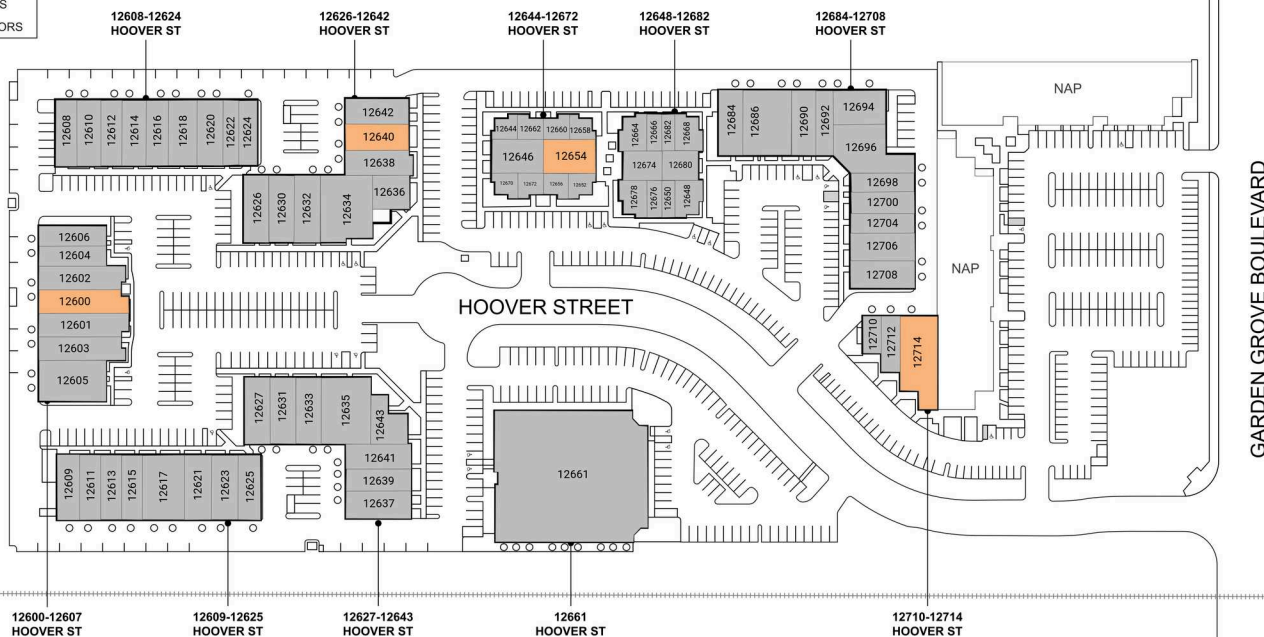

■ AVAILABLE ■ OCCUPIED

Current Availabilities

BUILDING	SUITE	TOTAL SIZE	OFFICE SIZE	OFFICE %	TYPE	CLEAR HT	GL	DL
A	12600	3,394	0	0	IND	N/A	N/A	
D	12640	1,540	0	0	IND	N/A	N/A	
F	12654	521	0	0	OFF	N/A	N/A	
J	12714	3,600	0	0	IND	N/A	N/A	

HOOVER BUSINESS PARK

12661 HOOVER STREET • STANTON, CA 90680



HOOVER BUSINESS PARK

12661 HOOVER STREET • STANTON, CA 90680

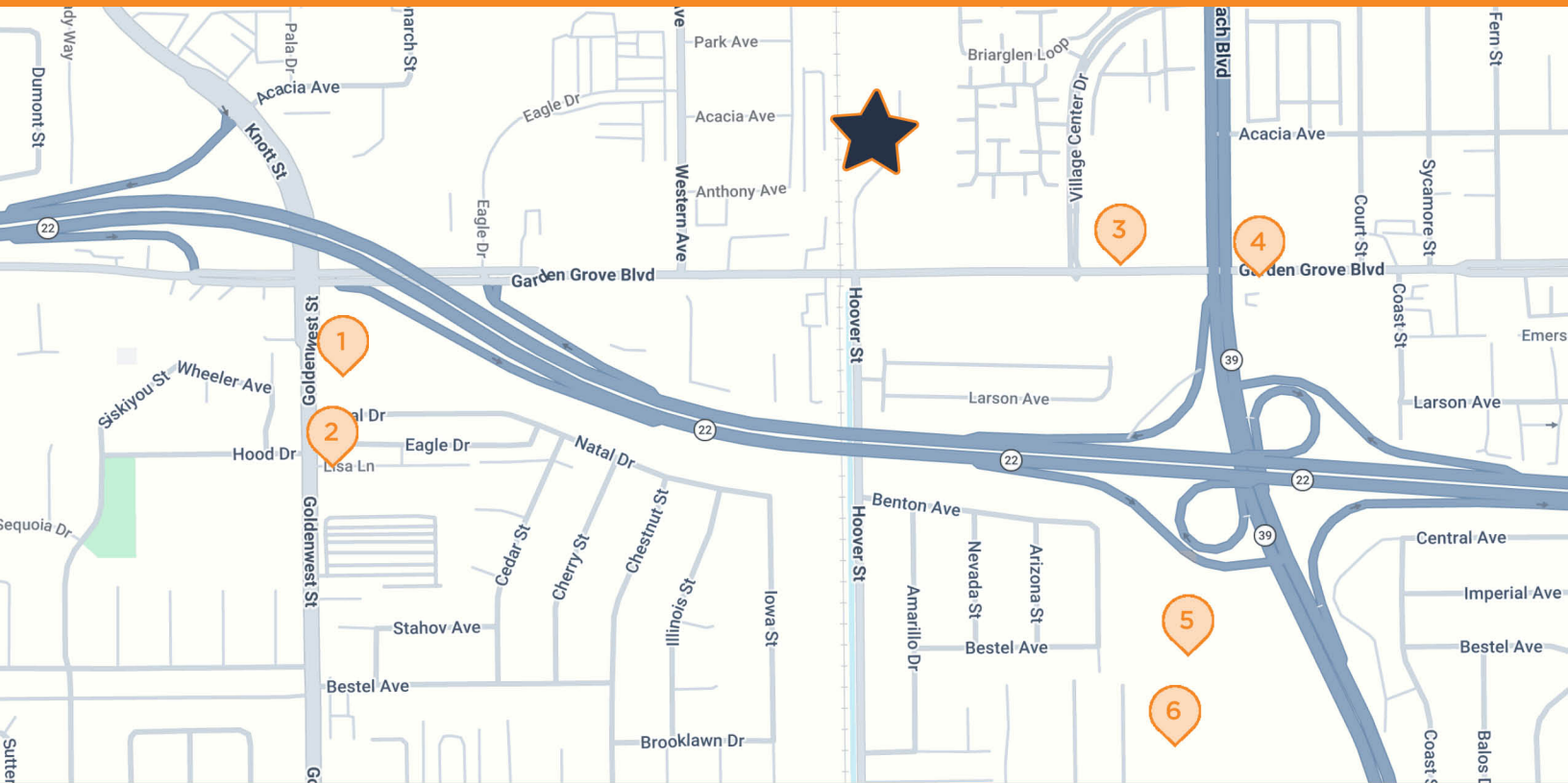

HOOVER BUSINESS PARK
12661 Hoover Street, Stanton, CA 90680

- 1 MOTEL 6**
13100 Goldenwest St, Westminster, CA
- 2 ARCO**
13142 Goldenwest St, Westminster, CA
- 3 THE UPS STORE**
7927 Garden Grove Blvd, Garden Grove, CA

- 4 STARBUCKS**
12950 Beach Blvd, Stanton, CA
- 5 COSTCO**
13225 Beach Blvd, Westminster, CA
- 6 WALMART**
13331 Beach Blvd, Westminster, CA