

EXPRESSWAY CORPORATE CENTER

3015, 3101-3131 S. Park Dr., 3010, 3110 And 3120 S. Potter Dr., 2307 & 2315 W. Fairmont Dr. Tempe, AZ 85282



Available SF
7,072-7,072 SF

Renovated
2025

Clear Height
-

Location
TEMPE, AZ



- 79,333 SF across ten buildings and 20' clear heights.
- Prime Tempe location near I-10 and US-60, minutes from Phoenix Sky Harbor International Airport.
- Ample parking and modern TPO roofing for long-term operational reliability.

FOR MORE INFORMATION

Ricky Borane
Leasing Manager
BKM Management Company
P. 602.362.0803
E. RBORANE@BKMMGMT.COM

EXPRESSWAY CORPORATE CENTER

3015, 3101-3131 S. Park Dr., 3010, 3110 And 3120 S. Potter Dr., 2307 & 2315 W. Fairmont Dr. Tempe, AZ 85282



LEGEND

- ▲ DOCK HIGH DOORS
- GRADE LEVEL DOORS

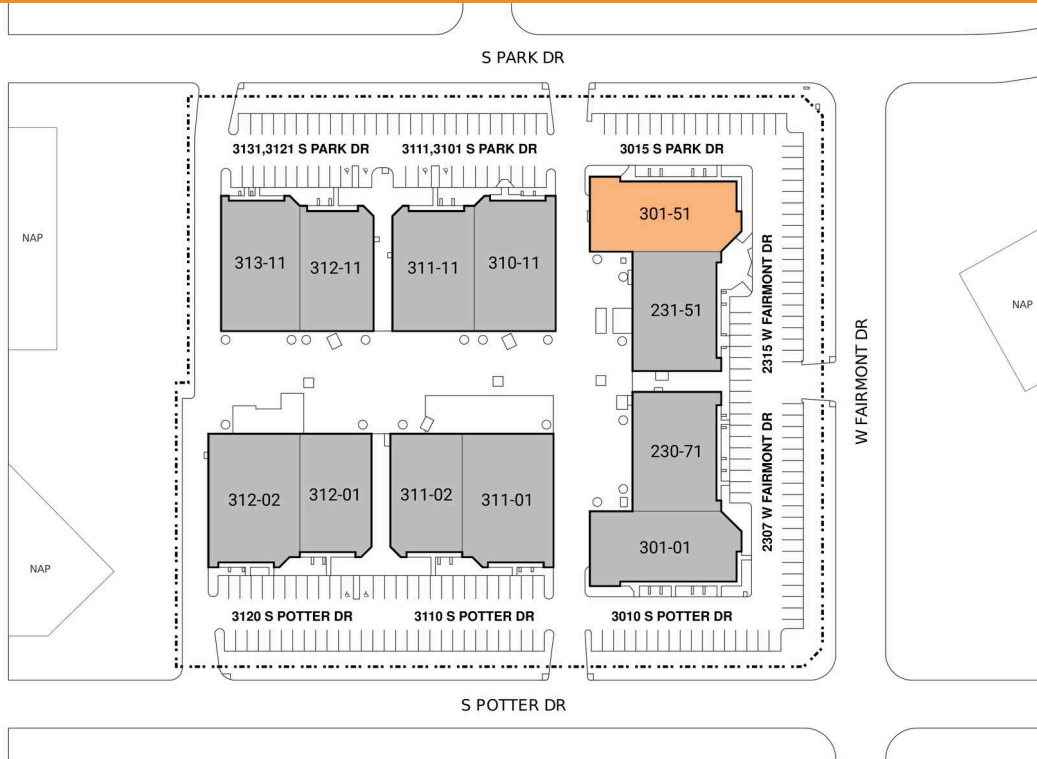

● AVAILABLE ● OCCUPIED

CURRENT AVAILABILITIES

BUILDING	SUITE	TOTAL SF	OFFICE SF	OFFICE %	TYPE	CLEAR HT	GL	DL
	301-51	7,072	0	0%	N/A	15	1	0

EXPRESSWAY CORPORATE CENTER

3015, 3101-3131 S. Park Dr., 3010, 3110 And 3120 S. Potter Dr., 2307 & 2315 W.
Fairmont Dr. Tempe, AZ 85282



EXPRESSWAY CORPORATE CENTER



3015, 3101-3131 S. Park Dr., 3010, 3110 And 3120 S. Potter Dr., 2307 & 2315 W. Fairmont Dr. Tempe, AZ 85282

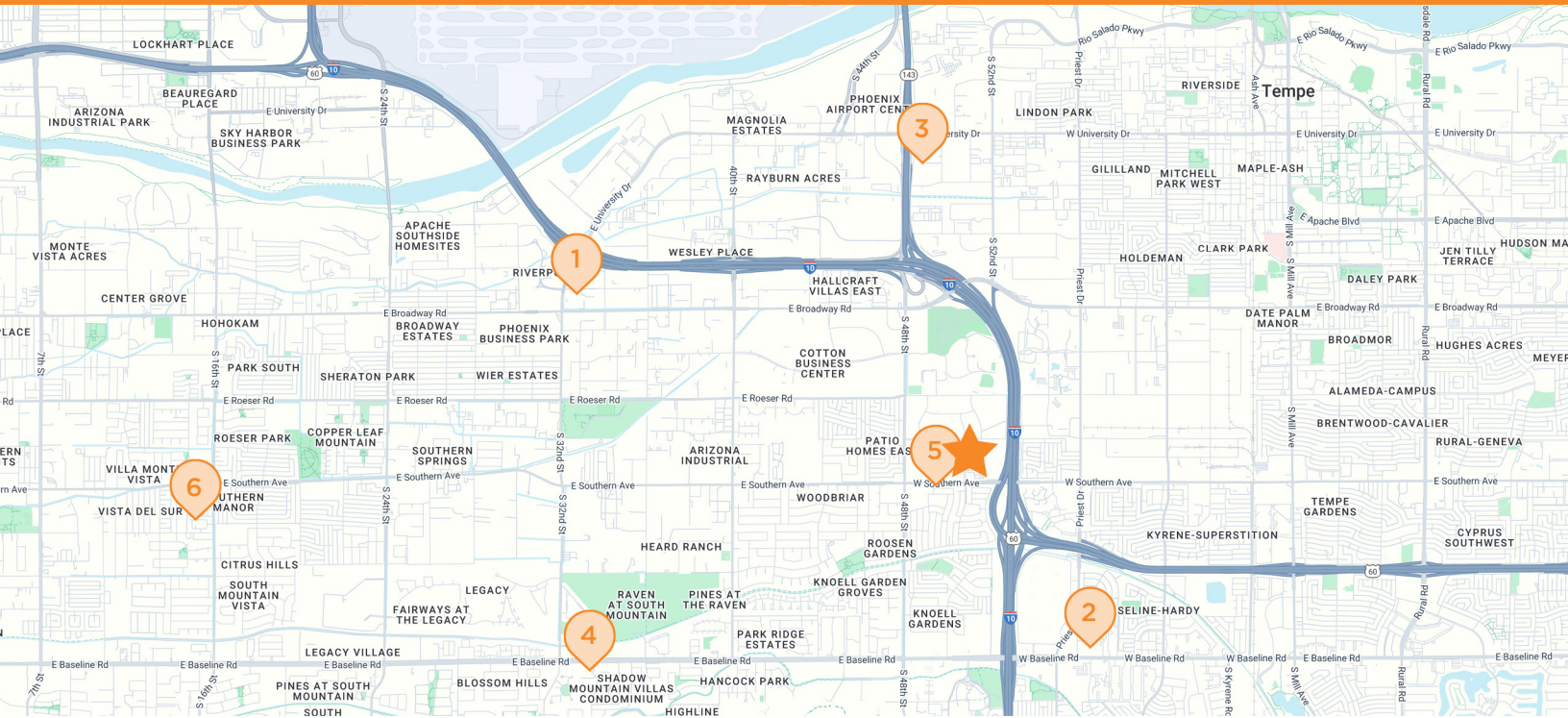

 **EXPRESSWAY CORPORATE CENTER**
3015, 3101-3131 S. Park Dr., 3010, 3110 and 3120 S. Potter Dr., 2307 & 2315 W. Fairmont Dr., Tempe, AZ 85282

-  **1 ARCO**
1725 Arnold Industrial Pl
Concord, CA
-  **2 HAMPTON INN**
1785 Pine St
Concord, CA
-  **3 SAFEWAY**
2600 Willow Pass Rd
Concord, CA
-  **4 COSTCO WHOLESALE**
2400 Monument Blvd
Concord, CA
-  **5 STARBUCKS**
3373 Port Chicago Hwy
Concord, CA
-  **6 CHASE BANK**
2097 Salvio St
Concord, CA