

ORION COMMERCE PARK

124-125 & 136 W. Orion St., 6100 S. Maple Ave., 6105 & 6125 S. Ash Ave. Tempe, AZ 85283



Available SF
1,176-4,368 SF

Renovated
2025

Clear Height
18'

Location
TEMPE, AZ



- 177,354 SF spread across nine buildings.
- Centrally located in Tempe with direct access to Loop 101, US-60, and Phoenix Sky Harbor International Airport.
- Unit sizes support a wide range of tenant requirements.
- Clear heights of 18' and multiple loading options enhance operational capabilities.

FOR MORE INFORMATION

Ricky Borane
Leasing Manager
BKM Management Company
P. 602.362.0803
E. RBORANE@BKMMGMT.COM

ORION COMMERCE PARK

124-125 & 136 W. Orion St., 6100 S. Maple Ave., 6105 & 6125 S. Ash Ave. Tempe, AZ 85283



LEGEND
 ▲ DOCK HIGH DOORS
 ○ GRADE LEVEL DOORS

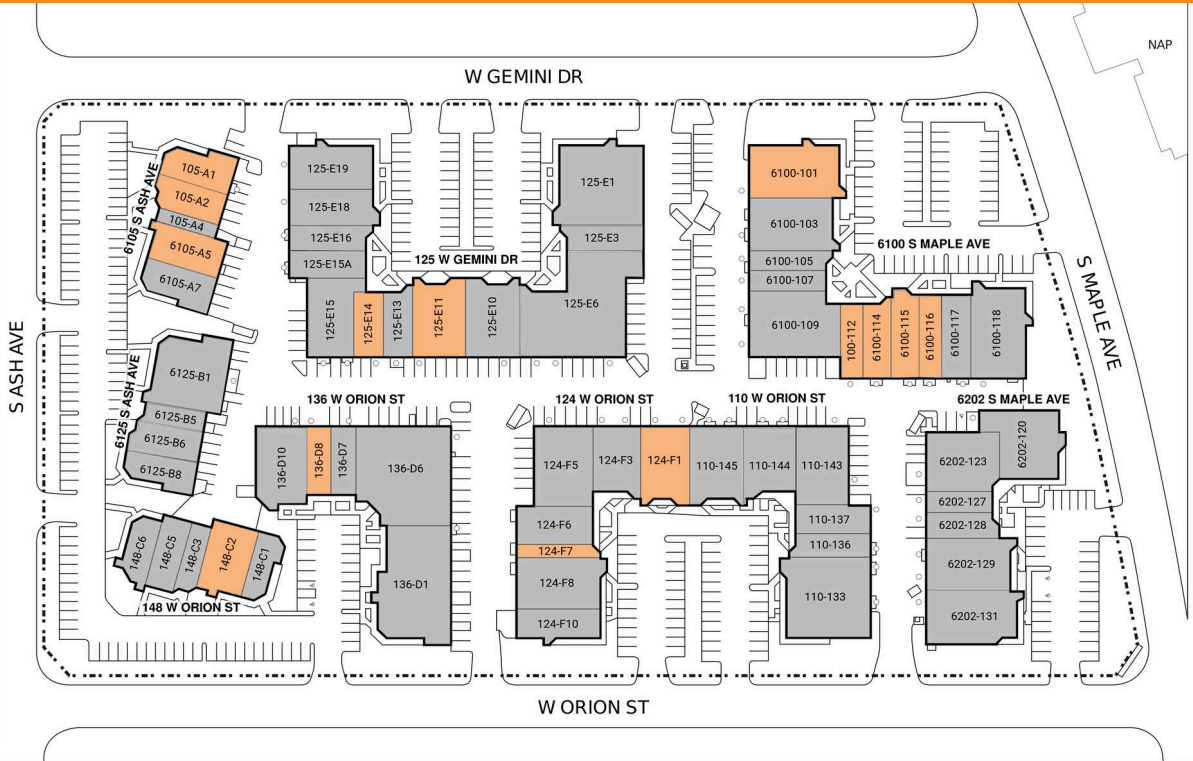

● AVAILABLE ● OCCUPIED

CURRENT AVAILABILITIES

BUILDING	SUITE	TOTAL SF	OFFICE SF	OFFICE %	TYPE	CLEAR HT	GL	DL
	100-112	1,632	939	54%	N/A	16	1	0
	105-A1	1,176	2,030	39%	N/A	14	1	0
	105-A2	2,332	2,030	39%	N/A	14	1	0
	124-F1	3,506	0	0%	N/A	15	2	0
	124-F7	1,817	1,862	100%	N/A	0	1	0
	125-E11	2,736	1,520	55%	N/A	10	1	0
	125-E14	1,543	752	48%	N/A	16	1	0
	136-D8	1,582	1,582	100%	N/A	0	1	0
	148-C2	2,150	905	42%	N/A	15	0	0
	6100-101	4,368	4,485	100%	N/A	0	1	0
	6100-114	1,686	471	26%	N/A	15	1	0
	6100-115	2,067	1,441	38%	N/A	15	2	0
	6100-116	1,972	2,275	60%	N/A	15	2	0
	6105-A5	2,320	1,202	52%	N/A	14	1	0

ORION COMMERCE PARK

124-125 & 136 W. Orion St., 6100 S. Maple Ave., 6105 & 6125 S. Ash Ave. Tempe, AZ 85283

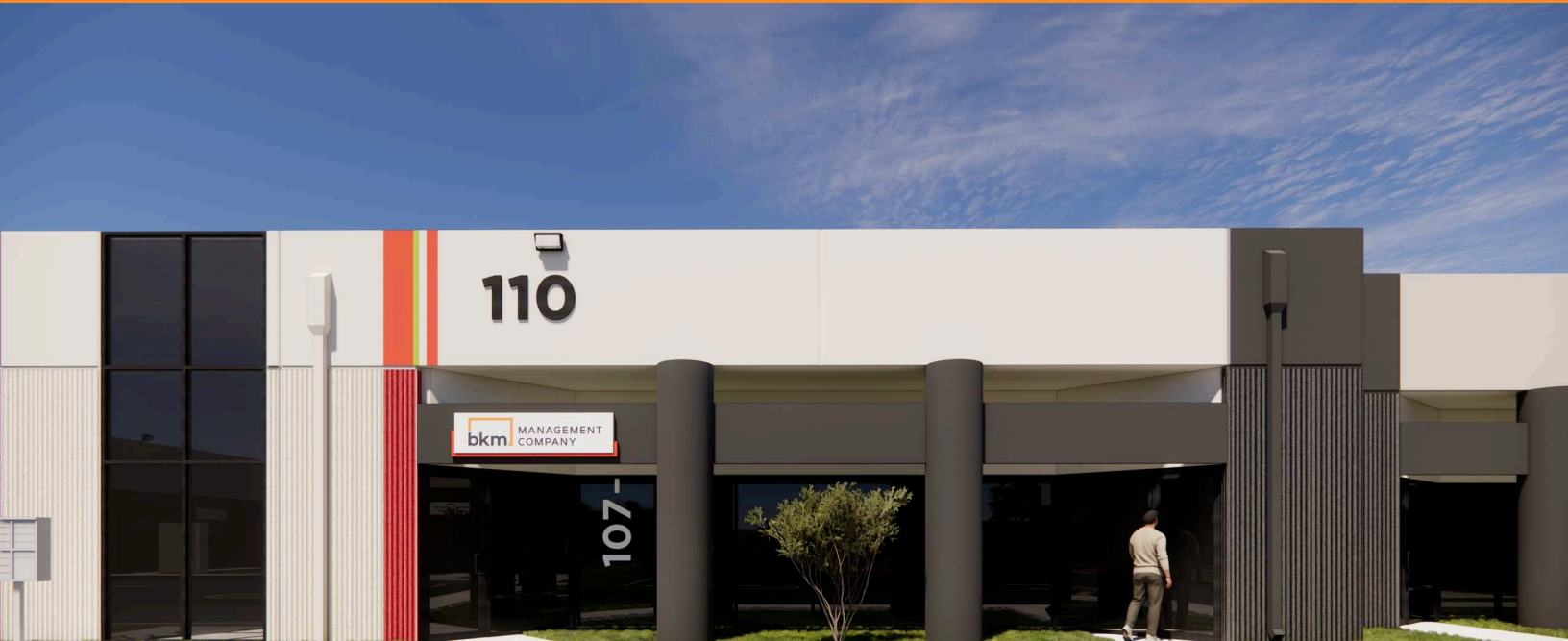

ORION COMMERCE PARK

124-125 & 136 W. Orion St., 6100 S. Maple Ave., 6105 & 6125 S. Ash Ave. Tempe, AZ 85283

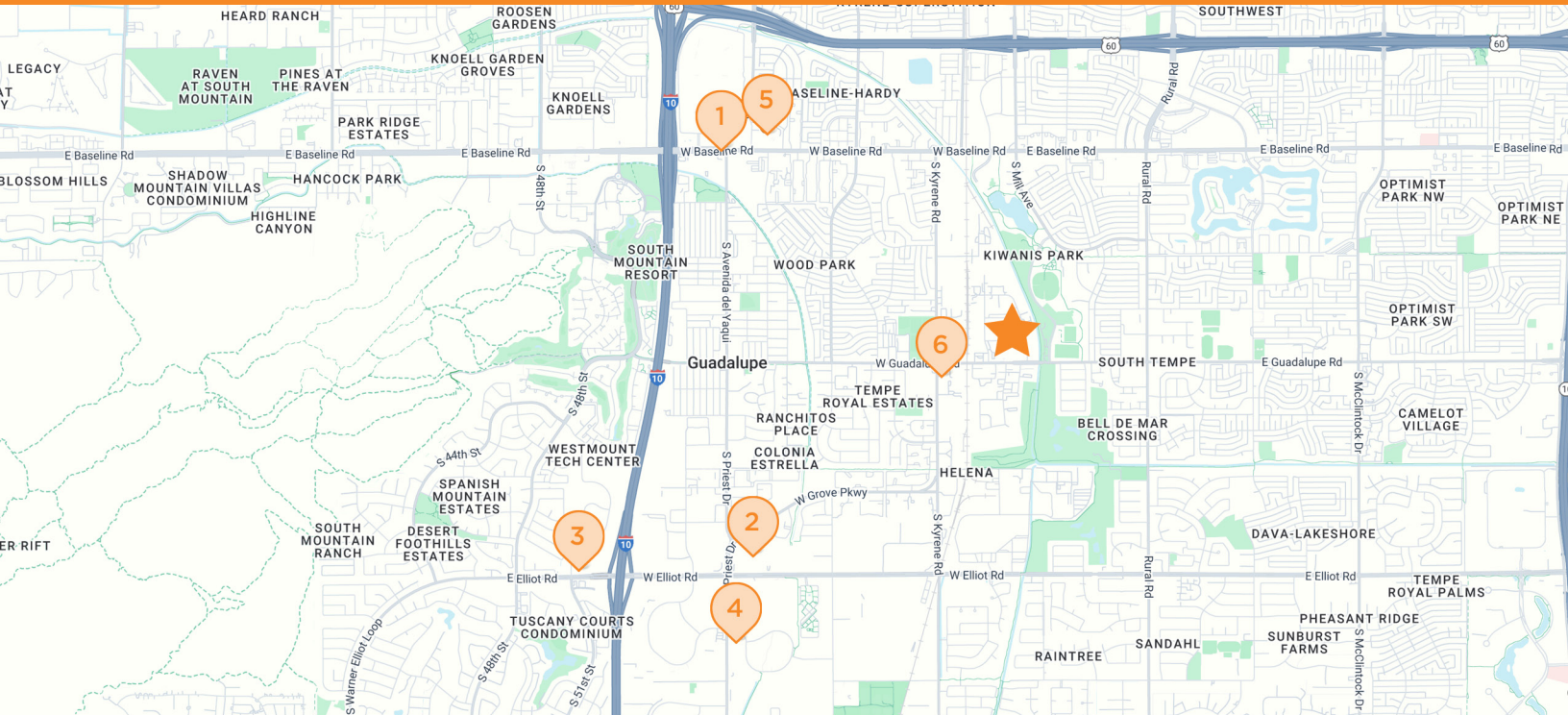

 **ORION COMMERCE PARK**
124-125 & 136 W. Orion St., 6100 S. Maple Ave., 6105 & 6125 S. Ash Ave., Tempe, AZ 85283

 **1 HOLIDAY INN**
1520 W Baseline Rd
Tempe, AZ

 **2 WALMART**
1380 W Elliot Rd
Tempe, AZ

 **3 WELLS FARGO BANK**
10651 S 51st St
Tempe, AZ

 **4 THE FIX COFFEE**
1445 W Auto Dr
Tempe, AZ

 **5 THE HOME DEPOT**
1330 W Baseline Rd
Tempe, AZ

 **6 CHEVRON**
475 W Guadalupe Rd
Tempe, AZ