

# CONCORD BUSINESS PARK

1590 Solano Way & 5600-5750 Imhoff Drive Concord, CA 94520



Available SF  
**2,520-3,120 SF**

Renovated  
**2024**

Clear Height  
**-**

Location  
**CONCORD, CA**



- Excellent North Concord location
- Located 1 block from HWY 4 on-ramp and less than 0.5 miles to HWY 4 & I-680 interchange
- Drive-around truck access
- Clean, well landscaped grounds
- Offers a variety of sizes and configurations
- 16' Clear height in most warehouses

## FOR MORE INFORMATION

### Colby Mikulich

Leasing Contact  
P. 510.370.2864  
E. [CMIKULICH@BKMMGMT.COM](mailto:CMIKULICH@BKMMGMT.COM)

### Tyler Epting

Leasing Agent  
Cushman & Wakefield  
P. 925 627 2897  
E. [TYLER.EPTING@CUSHWAKE.COM](mailto:TYLER.EPTING@CUSHWAKE.COM)

### Kris Hagar

Leasing Agent  
Cushman & Wakefield  
P. 925 627 2497  
E. [KRIS.HAGAR@CUSHWAKE.COM](mailto:KRIS.HAGAR@CUSHWAKE.COM)

# CONCORD BUSINESS PARK

1590 Solano Way & 5600-5750 Imhoff Drive Concord, CA 94520



**LEGEND**

- ▲ DOCK HIGH DOORS
- GRADE LEVEL DOORS

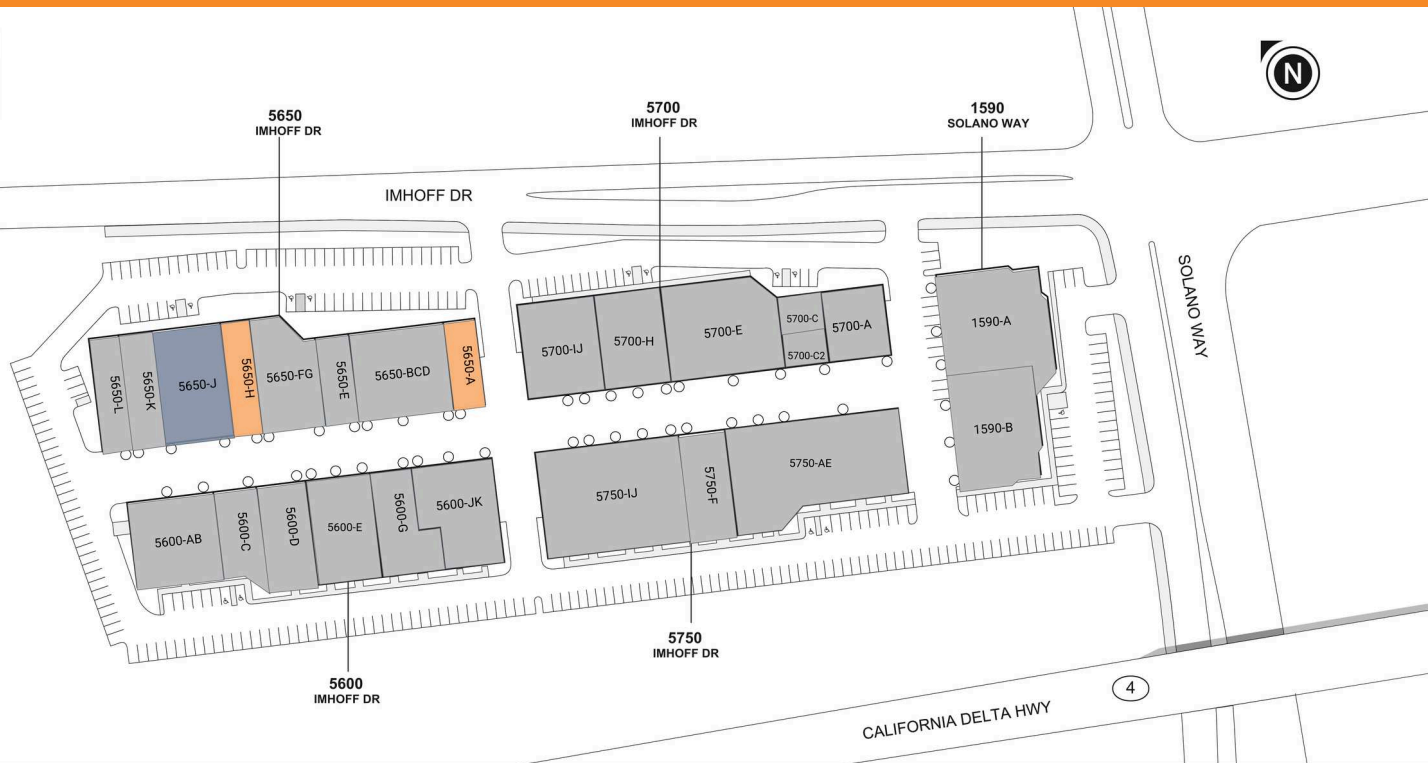

● AVAILABLE   ● COMING AVAILABLE   ● OCCUPIED

## CURRENT AVAILABILITIES

BUILDING	SUITE	TOTAL SF	OFFICE SF	OFFICE %	TYPE	CLEAR HT	GL	DL
5650	5650-A	2,520	1,199	48%	IND	18	1	0
5650	5650-H	3,120	784	25%	IND	18	1	0

## COMING AVAILABLE

BUILDING	SUITE	TOTAL SF	OFFICE SF	OFFICE %	TYPE	CLEAR HT	GL	DL	DATE AVAILABLE	FLOOR PLAN
5650	5650-J	6,240	1,421	23%	IND	18	2	0	N/A	<a href="#">View Plan</a>

# CONCORD BUSINESS PARK

1590 Solano Way & 5600-5750 Imhoff Drive Concord, CA 94520



# CONCORD BUSINESS PARK

1590 Solano Way & 5600-5750 Imhoff Drive Concord, CA 94520

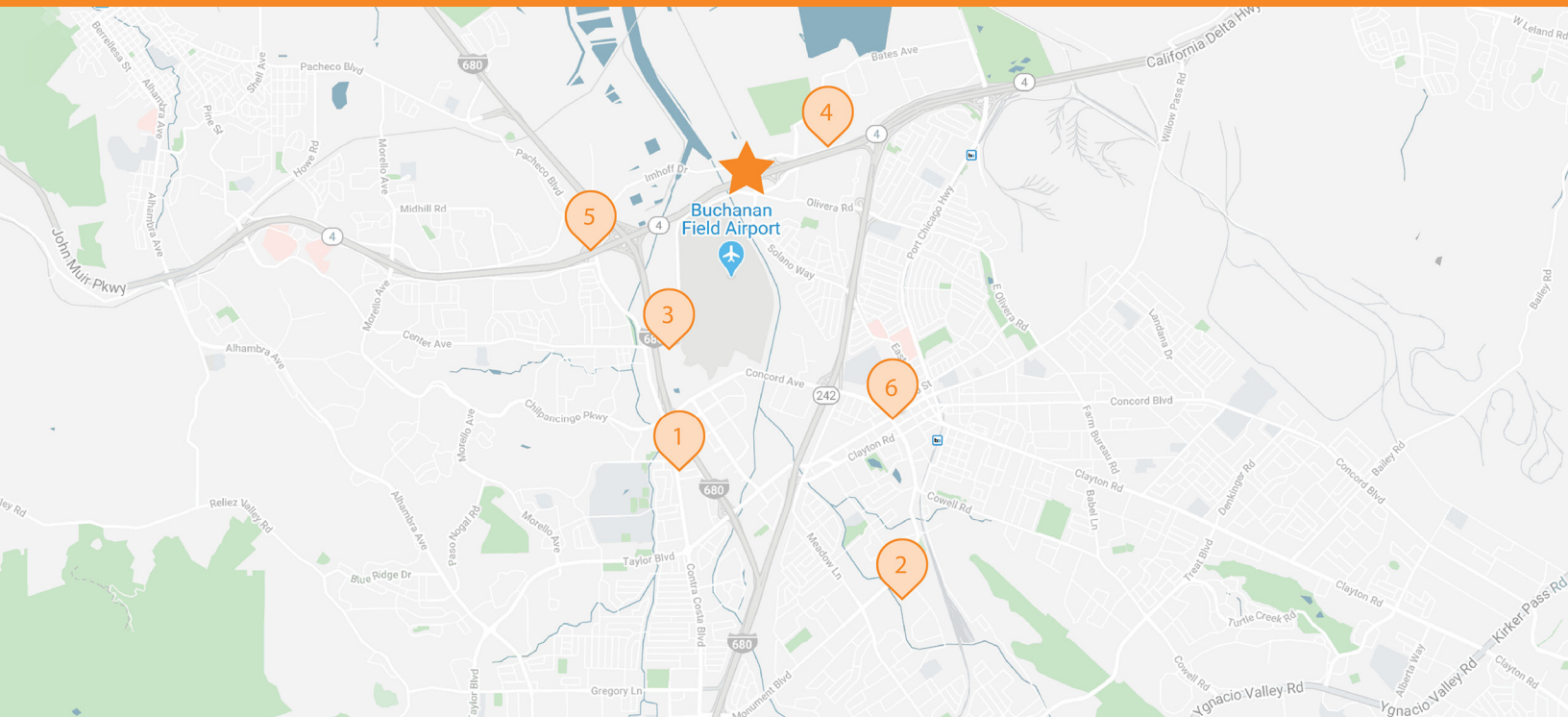

## CONCORD BUSINESS PARK

1590 Solano Way & 5600-5750 Imhoff Dr, Concord, CA 94520



### WELLS FARGO

699 Contra Costa Blvd.  
Concord, CA



### COSTCO WHOLESALE

2400 Monument Blvd.  
Concord, CA



### FEDEX

115 Center Ave.  
Concord, CA



### LOWES

1935 Arnold Industrial  
Concord, CA



### US POST OFFICE

4980 Pacheco Blvd.  
Concord, CA



### PETE'S COFFEE

2072 Salvio St.  
Concord, CA