

BUTTES BUSINESS PARK

2105 - 2231 S. 48th Tempe, AZ 85282



Available SF
800-2,860 SF

Renovated
2025

Clear Height
-

Location
TEMPE, AZ



- 188,282 SF across 13 buildings in a highly visible Tempe location.
- Positioned near I-10, Loop 202, and Phoenix Sky Harbor International Airport for regional access.
- Wide range of suite sizes supports office, showroom, and light industrial tenants.
- Features 68 grade-level doors, ample parking, and strong curb appeal for tenant branding.

FOR MORE INFORMATION

Chad Torres

Leasing Manager

P. 602-325-8492

E. CTORRES@BKMMGMT.COM

BUTTES BUSINESS PARK

2105 - 2231 S. 48th Tempe, AZ 85282



LEGEND

- ▲ DOCK HIGH DOORS
- GRADE LEVEL DOORS

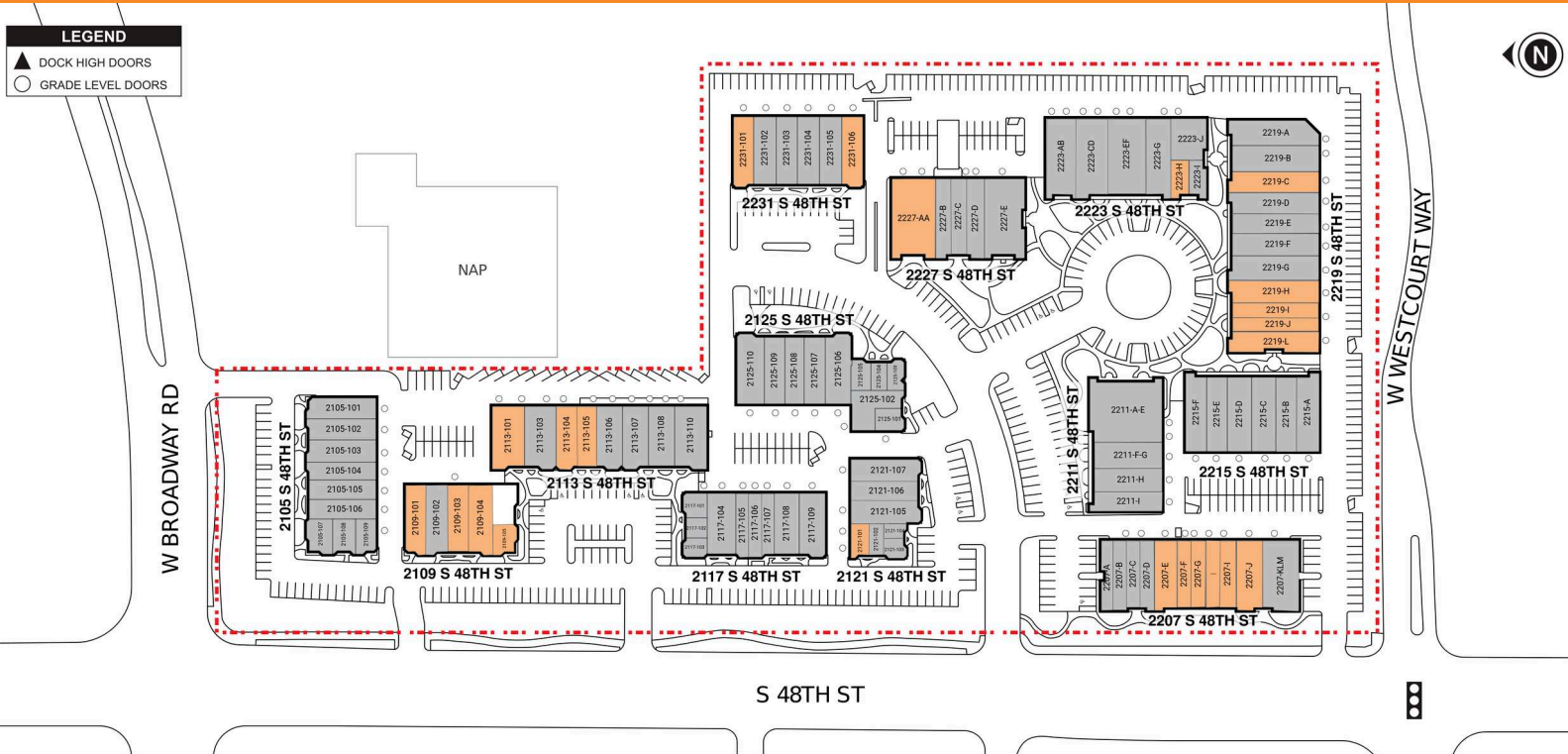

● AVAILABLE ● OCCUPIED

CURRENT AVAILABILITIES

BUILDING	SUITE	TOTAL SIZE	OFFICE SIZE	OFFICE %	TYPE	CLEAR HT	GL	DL
N/A	2109-101	1,920	545	28	N/A	1	0	
N/A	2109-103	1,920	802	38	N/A	1	0	
N/A	2109-104	1,920	605	31	N/A	1	0	
N/A	2109-105	1,080	1,113	45	N/A	0	0	
N/A	2113-101	1,728	1,758	100	N/A	1	0	
N/A	2113-104	1,728	2,777	80	N/A	1	0	
N/A	2113-105	1,728	2,777	80	N/A	1	0	
N/A	2121-101	800	1,593	76	N/A	1	0	
N/A	2207-E	1,640	1,035	63	N/A	1	0	
N/A	2207-F	1,640	1,211	37	N/A	2	0	
N/A	2207-G	1,640	1,211	37	N/A	2	0	
2207-H								
N/A	2207-I	1,640	1,135	34	N/A	2	0	
N/A	2207-J	1,640	507	31	N/A	1	0	
N/A	2219-C	2,550	1,000	38	N/A	1	0	
N/A	2219-H	2,550	1,638	64	N/A	1	0	
N/A	2219-I	1,530	0	0	N/A	1	0	

BUTTES BUSINESS PARK

2105 - 2231 S. 48th Tempe, AZ 85282



LEGEND

- ▲ DOCK HIGH DOORS
- GRADE LEVEL DOORS

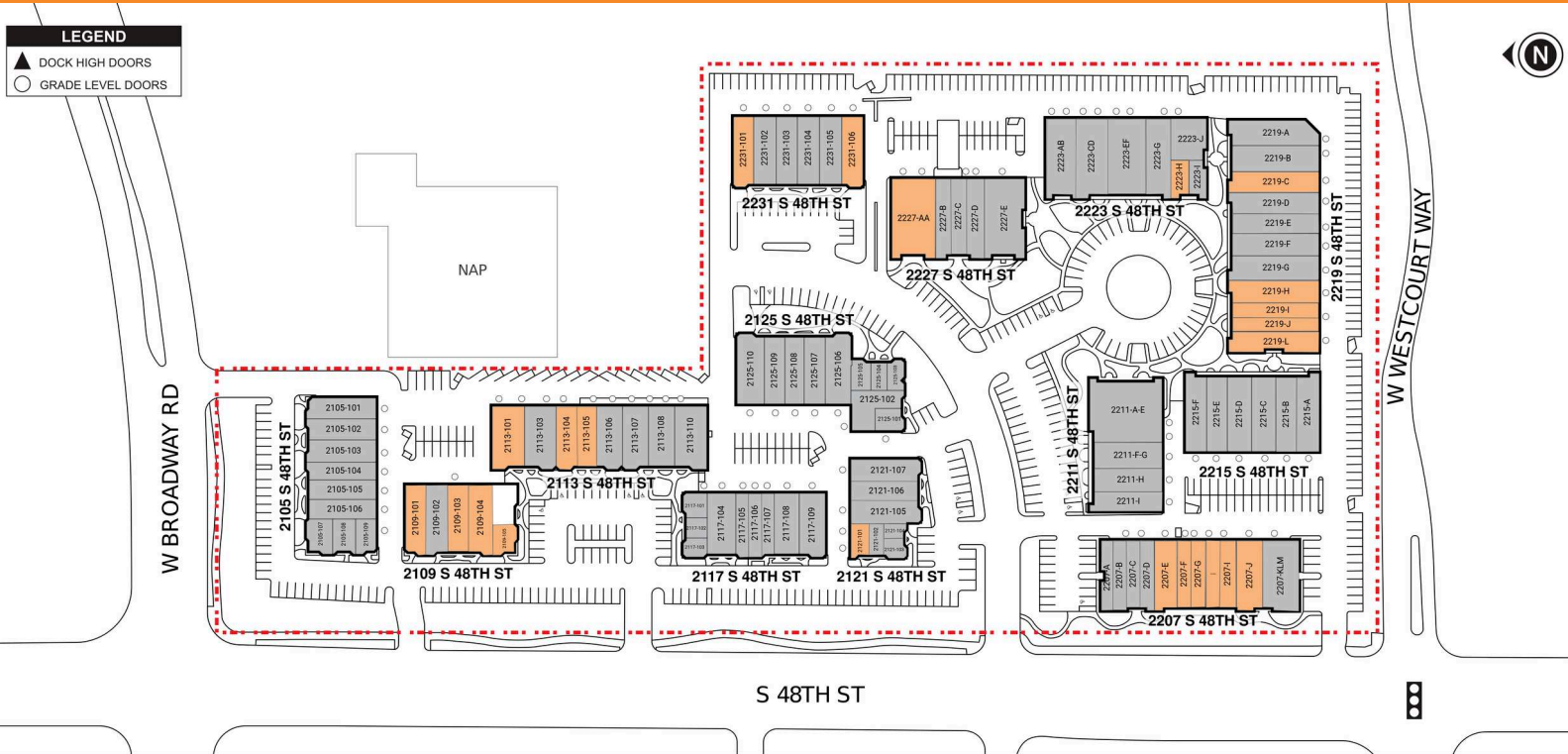

● AVAILABLE ● OCCUPIED

CURRENT AVAILABILITIES

BUILDING	SUITE	TOTAL SIZE	OFFICE SIZE	OFFICE %	TYPE	CLEAR HT	GL	DL
N/A	2219-J	2,550	0	0	N/A	1	0	
N/A	2219-L	1,530	0	0	N/A	0	0	
N/A	2223-H	900	910	100	N/A	0	0	
N/A	2227-AA	2,860	1,449	51	N/A	1	0	
N/A	2231-101	2,000	905	45	N/A	1	0	
N/A	2231-106	2,000	398	20	N/A	1	0	

BUTTES BUSINESS PARK

2105 - 2231 S. 48th Tempe, AZ 85282



BUTTES BUSINESS PARK

2105 - 2231 S. 48th Tempe, AZ 85282

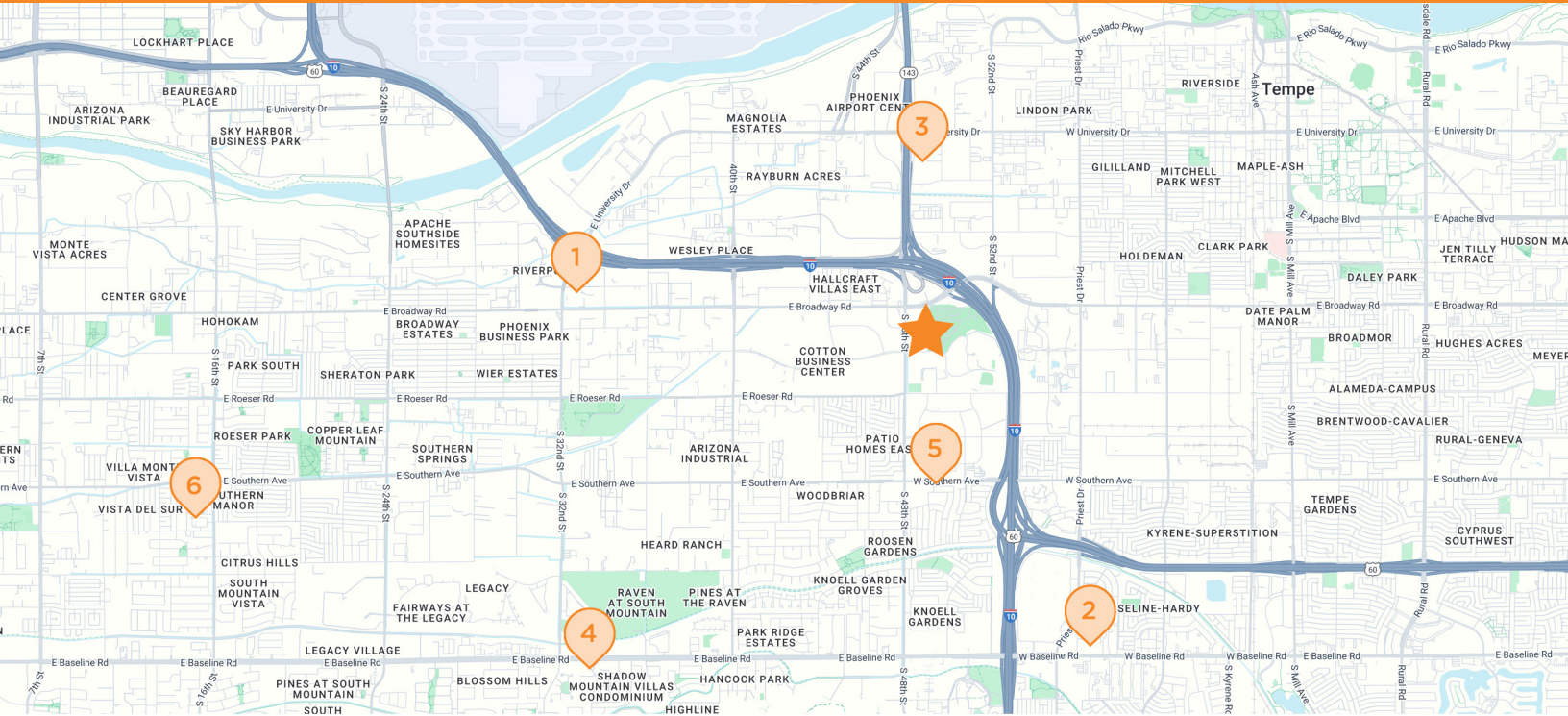

BUTTES BUSINESS PARK

2105 - 2231 S. 48th, Tempe, AZ 85282

- 1 ARCO**
1725 Arnold Industrial Pl
Concord, CA
- 2 HAMPTON INN**
1785 Pine St
Concord, CA
- 3 SAFEWAY**
2600 Willow Pass Rd
Concord, CA
- 4 COSTCO WHOLESALE**
2400 Monument Blvd
Concord, CA
- 5 STARBUCKS**
3373 Port Chicago Hwy
Concord, CA
- 6 CHASE BANK**
2097 Salvio St
Concord, CA