

# CAMPUS DISTRIBUTION

4640 Campus Place Mukilteo, WA 98275



Available SF  
**10,560-19,685 SF**

Renovated  
**2022**

Clear Height  
**16'-20'**

Location  
**MUKILTEO, WA**



- Small-bay industrial building serving the Everett/Mukilteo manufacturing corridor
- Functional warehouse space with grade-level loading
- Convenient access to SR-526 and regional aerospace and industrial employers

## FOR MORE INFORMATION

### **Nicolina Merlino**

Leasing Manager  
BKM Management  
P. 206.487.7044  
E. [NMERLINO@BKMMGMT.COM](mailto:NMERLINO@BKMMGMT.COM)

### **Rawley Holmberg**

Senior Leasing Manager  
P. 425.274.4284  
E. [HOLMBERG@BRODERICKGROUP.COM](mailto:HOLMBERG@BRODERICKGROUP.COM)

### **Connor Gilchrist**

Leasing Agent  
P. 425.274.4284  
E. [HOLMBERG@BRODERICKGROUP.COM](mailto:HOLMBERG@BRODERICKGROUP.COM)

# CAMPUS DISTRIBUTION

4640 Campus Place Mukilteo, WA 98275



**LEGEND**

- ▲ DOCK HIGH DOORS
- GRADE LEVEL DOORS

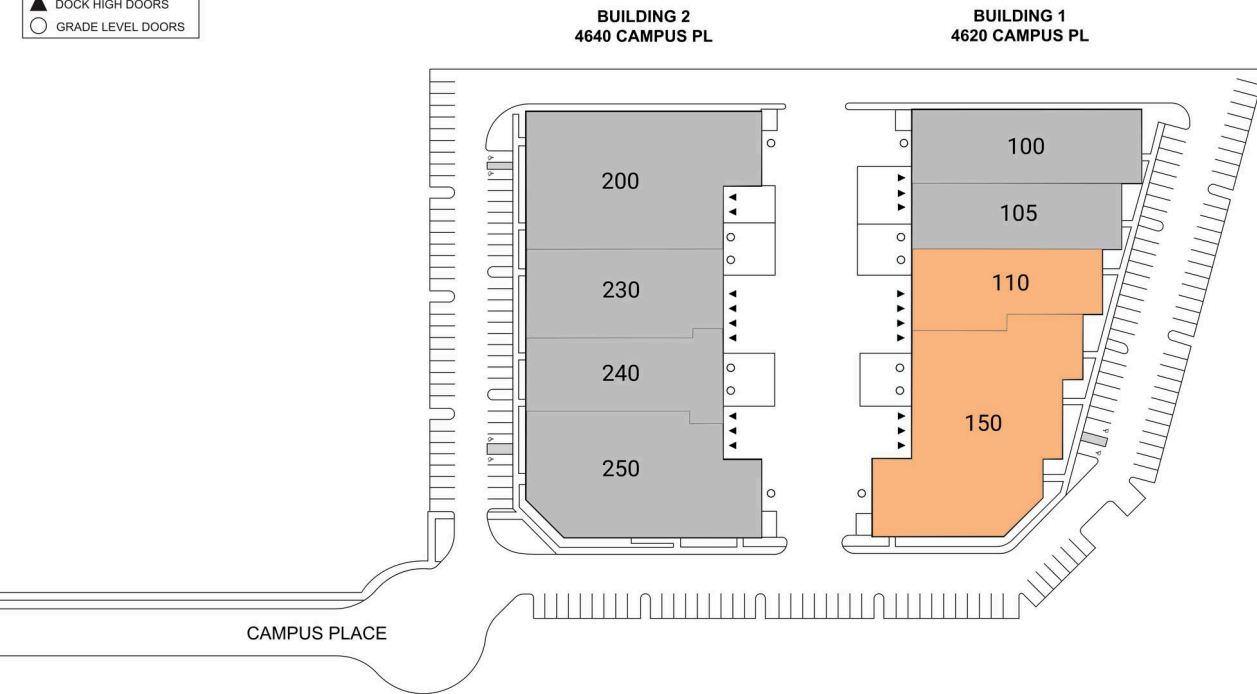

● AVAILABLE ● OCCUPIED

## CURRENT AVAILABILITIES

BUILDING	SUITE	TOTAL SF	OFFICE SF	OFFICE %	TYPE	CLEAR HT	GL	DL
1	110	10,560	0	0%	IND	N/A	N/A	N/A
1	150	19,685	0	0%	IND	N/A	N/A	N/A

# CAMPUS DISTRIBUTION

4640 Campus Place Mukilteo, WA 98275



# CAMPUS DISTRIBUTION

4640 Campus Place Mukilteo, WA 98275

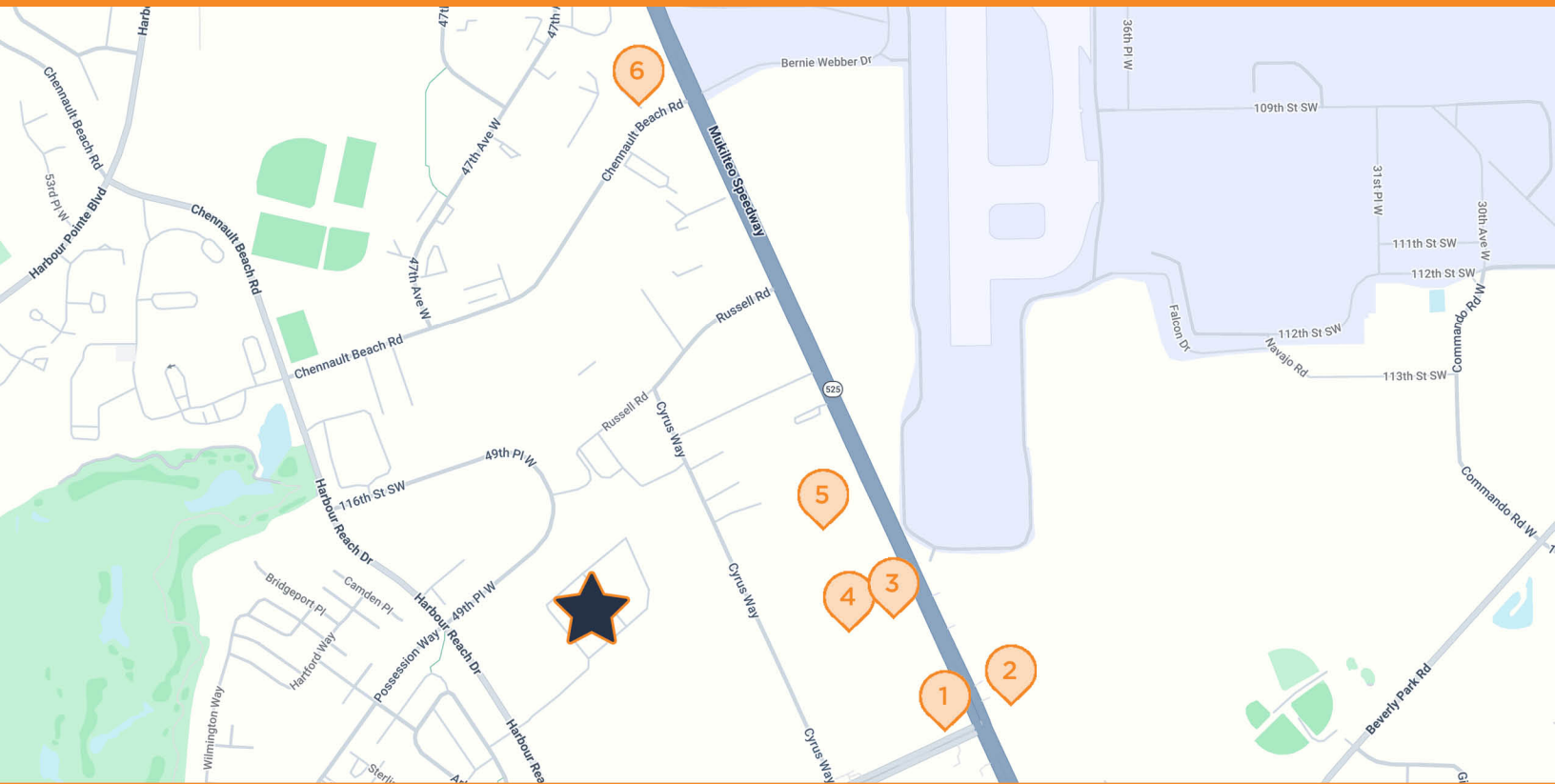

## CAMPUS DISTRIBUTION

4640 Campus Place, Mukilteo, WA 98275

- |          |   |          |  |
|----------|---|----------|--|
| <b>1</b> | <b>FEDEX SHIP CENTER</b><br>11700 Mukilteo Speedway, Mukilteo, WA | <b>4</b> | <b>SUBWAY</b><br>11700 Mukilteo Speedway, Mukilteo, WA   |
| <b>2</b> | <b>MCDONALDS</b><br>3717 Harbour Pointe Blvd SW, Mukilteo, WA     | <b>5</b> | <b>KEY BANK</b><br>11700 Mukilteo Speedway, Mukilteo, WA |
| <b>3</b> | <b>ARCO</b><br>3825 Harbour Pointe Blvd SW, Mukilteo, WA          | <b>6</b> | <b>SHELL</b><br>10900 Mukilteo Speedway, Mukilteo, WA    |