

WIER THIRTY6 BUSINESS PARK

3610-3660 E Wier Avenue & 4633-4645 S 36th Street Phoenix, AZ 85040



Available SF

Renovated

Clear Height

Location

PHOENIX, AZ

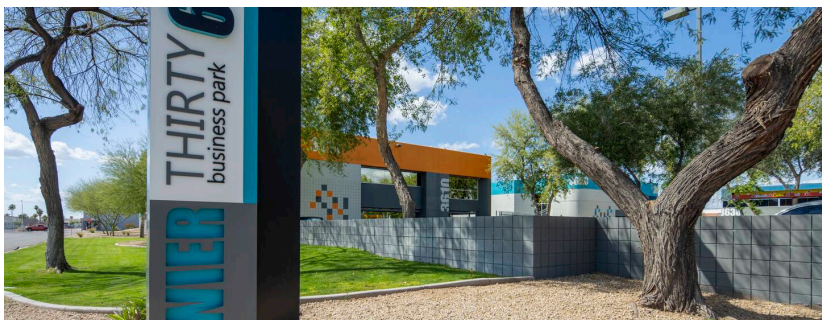

- Freestanding buildings with yards or truckwells
- Completely remodeled Oct 2018
- 18' ceiling height
- Evap cooled and A/C warehouse options
- 1/2 mile to I-10 freeway
- Business park environment
- Aggressive new ownership

FOR MORE INFORMATION

Ricky Borane

Leasing Manager
BKM Management Company
P. 602.362.0803
E. RBORANE@BKMMGMT.COM

Aric Adams

Leasing Agent
Kidder Mathews
P. 602.513.5119
E. AADAMS@KIDDERMATHEWS.COM

Mike Kasulaitis

Leasing Agent
Kidder Mathews
P. 602.513.5111
E. MIKEK@KIDDERMATHEWS.COM

WIER THIRTY6 BUSINESS PARK

3610-3660 E Wier Avenue & 4633-4645 S 36th Street Phoenix, AZ 85040



LEGEND

- ▲ DOCK HIGH DOORS
- GRADE LEVEL DOORS

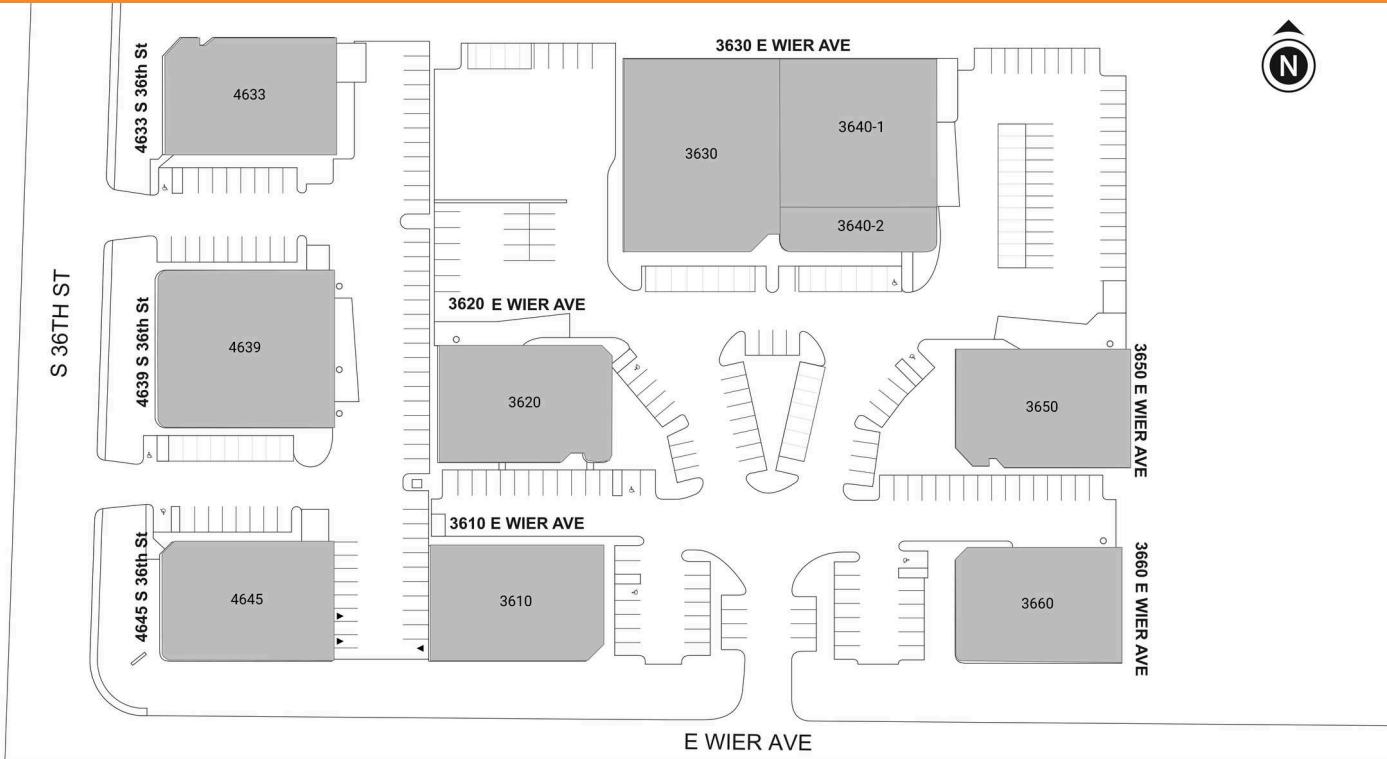

● AVAILABLE ● OCCUPIED

CURRENT AVAILABILITIES

BUILDING	SUITE	TOTAL SF	OFFICE SF	OFFICE %	TYPE	CLEAR HT	GL	DL
----------	-------	----------	-----------	----------	------	----------	----	----

WIER THIRTY6 BUSINESS PARK

3610-3660 E Wier Avenue & 4633-4645 S 36th Street Phoenix, AZ 85040



WIER THIRTY6 BUSINESS PARK

3610-3660 E Wier Avenue & 4633-4645 S 36th Street Phoenix, AZ 85040

