

SUITE DATA:

OFFICE 1,108 SF
 WAREHOUSE 6,400 SF
TOTAL 7,508 SF

CLEAR HEIGHT 15'-4" - 16'-8"
 ○ GRADE LEVEL DOORS 3

SITE KEY PLAN:

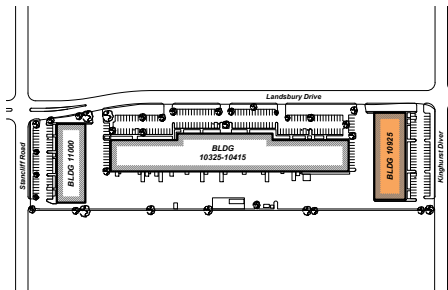

BUILDING KEY PLAN:

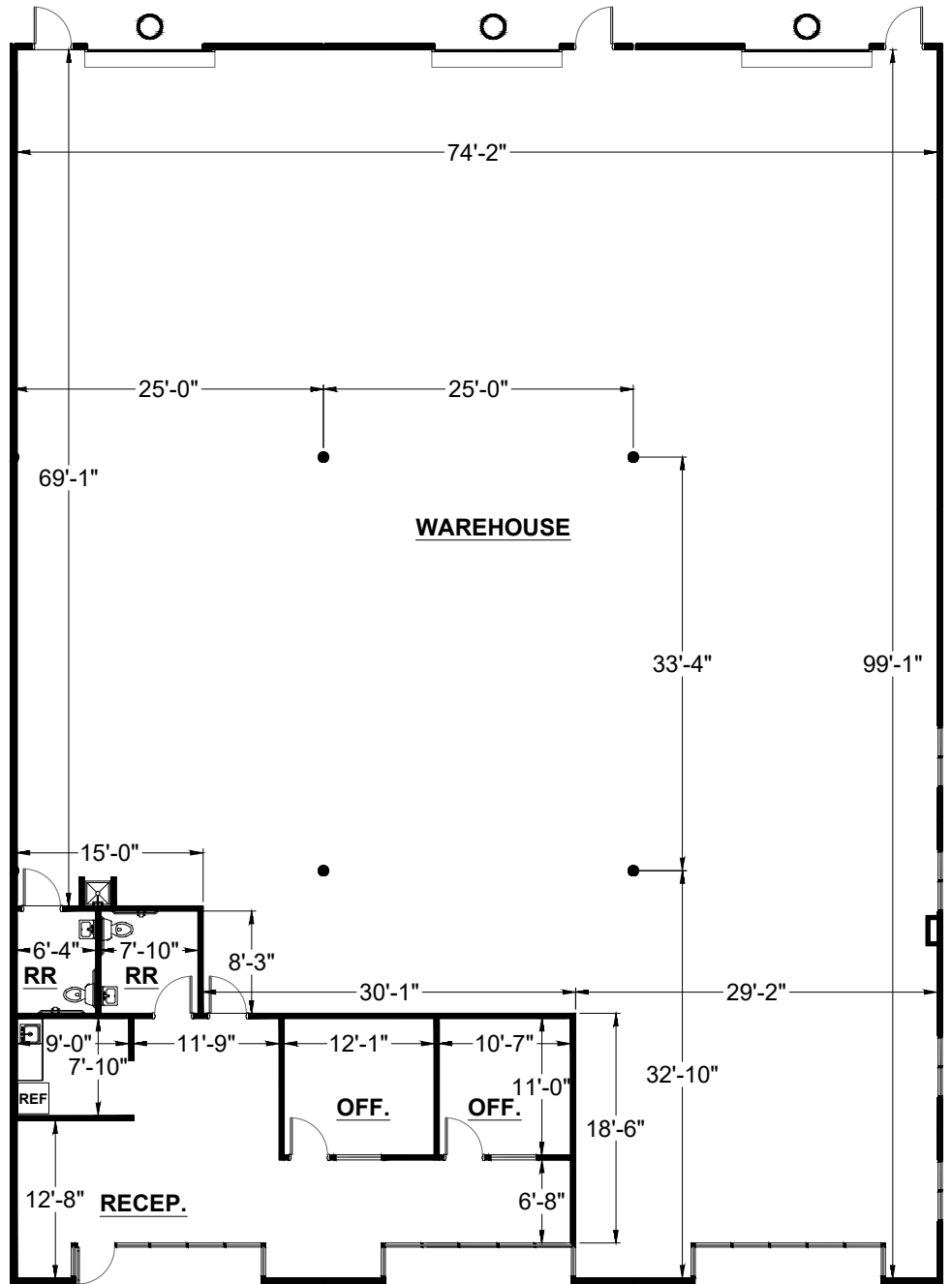
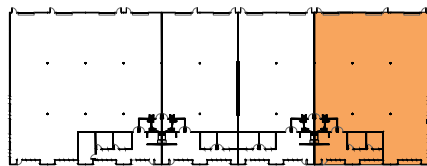

Southwest Business Park

10925 Kinghurst Drive
 Houston, TX 77099

Bldg. 10925
STE 540

05/20/26