

# EXPRESSWAY CORPORATE CENTER

3015, 3101-3131 S. Park Dr., 3010, 3110 And 3120 S. Potter Dr., 2307 & 2315 W. Fairmont Dr. Tempe, AZ 85282



Available SF  
**7,072-7,072 SF**

Renovated  
**2025**

Clear Height  
**20'**

Location  
**TEMPE, AZ**



## FOR MORE INFORMATION

### Ricky Borane

Leasing Manager

BKM Management Company

P. 602.362.0803

E. [RBORANE@BKMMGMT.COM](mailto:RBORANE@BKMMGMT.COM)

- 79,333 SF across ten buildings and 20' clear heights.
- Prime Tempe location near I-10 and US-60, minutes from Phoenix Sky Harbor International Airport.
- Ample parking and modern TPO roofing for long-term operational reliability.

# EXPRESSWAY CORPORATE CENTER

3015, 3101-3131 S. Park Dr., 3010, 3110 And 3120 S. Potter Dr., 2307 & 2315 W. Fairmont Dr. Tempe, AZ 85282



**LEGEND**

- ▲ DOCK HIGH DOORS
- GRADE LEVEL DOORS

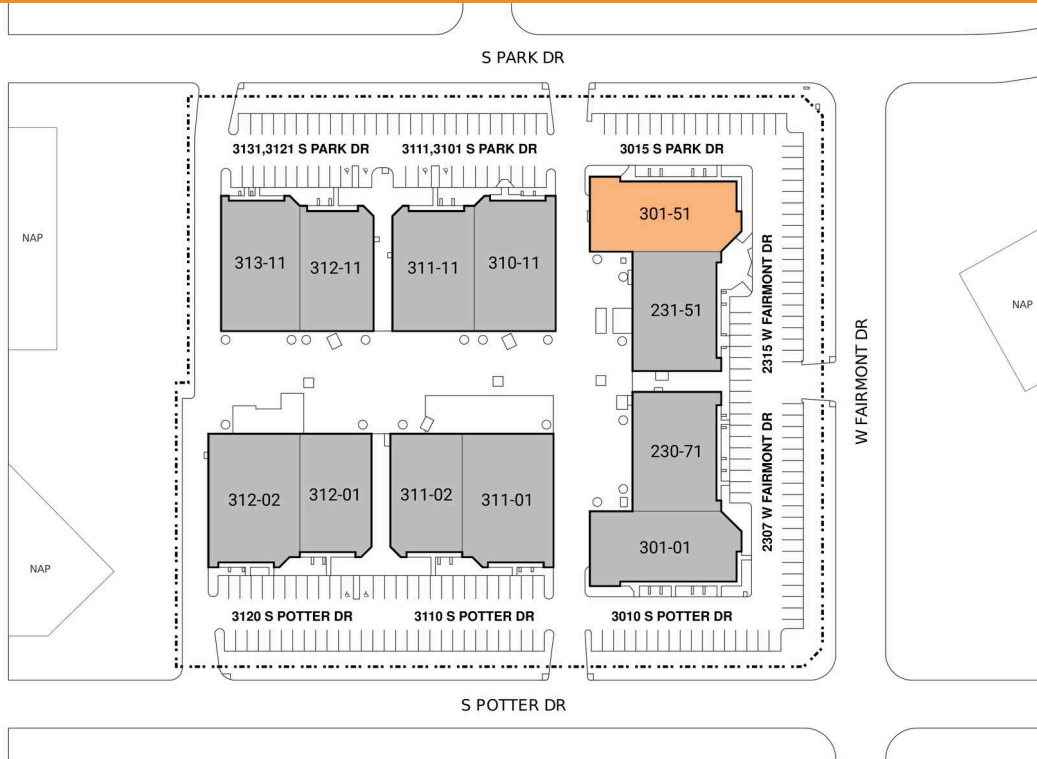

● AVAILABLE ● OCCUPIED

## CURRENT AVAILABILITIES

BUILDING	SUITE	TOTAL SF	OFFICE SF	OFFICE %	TYPE	CLEAR HT	GL	DL
	301-51	7,072	0	0%	N/A	15	1	0

# EXPRESSWAY CORPORATE CENTER

3015, 3101-3131 S. Park Dr., 3010, 3110 And 3120 S. Potter Dr., 2307 & 2315 W.  
Fairmont Dr. Tempe, AZ 85282



# EXPRESSWAY CORPORATE CENTER



3015, 3101-3131 S. Park Dr., 3010, 3110 And 3120 S. Potter Dr., 2307 & 2315 W. Fairmont Dr. Tempe, AZ 85282

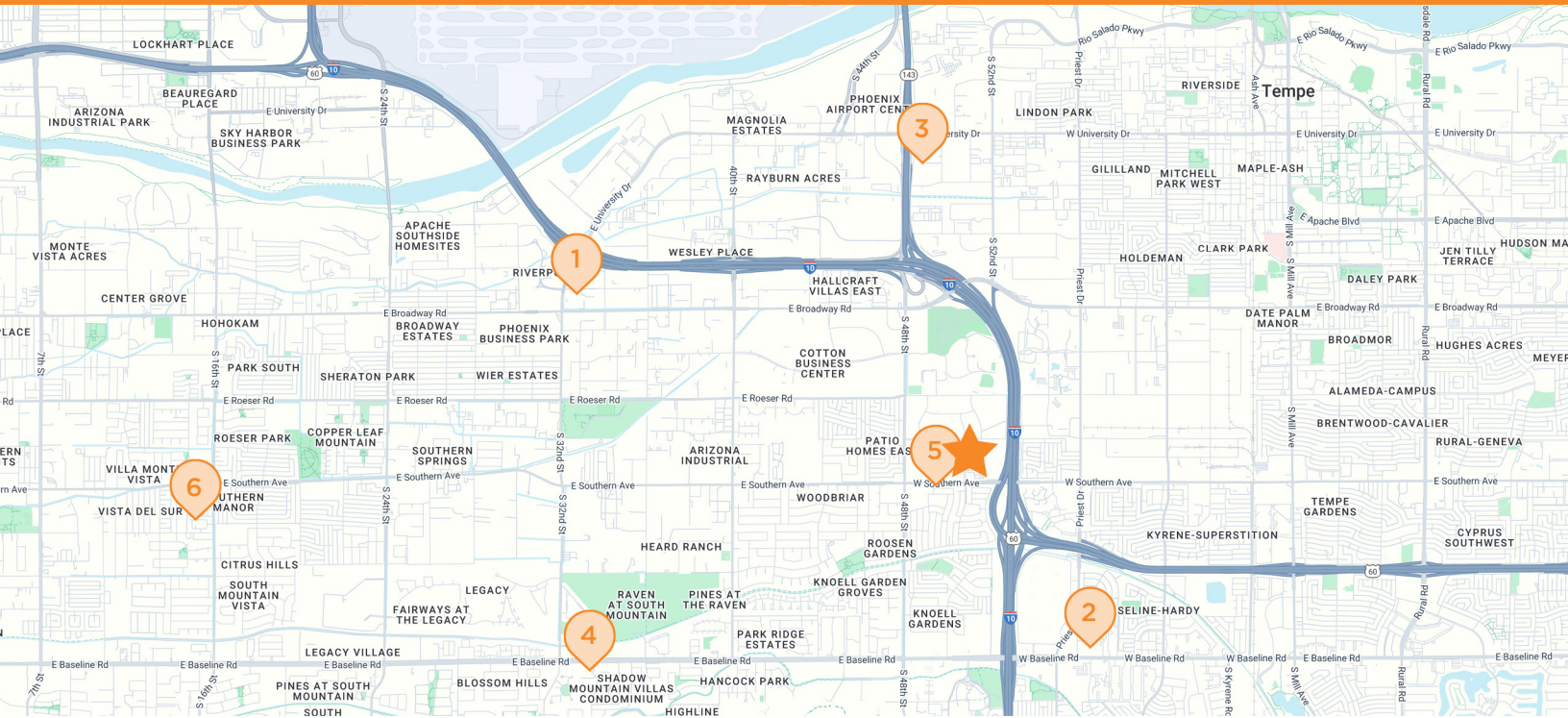

 **EXPRESSWAY CORPORATE CENTER**  
3015, 3101-3131 S. Park Dr., 3010, 3110 and 3120 S. Potter Dr., 2307 & 2315 W. Fairmont Dr., Tempe, AZ 85282

- 1 ARCO**  
1725 Arnold Industrial Pl  
Concord, CA
- 2 HAMPTON INN**  
1785 Pine St  
Concord, CA
- 3 SAFEWAY**  
2600 Willow Pass Rd  
Concord, CA
- 4 COSTCO WHOLESALE**  
2400 Monument Blvd  
Concord, CA
- 5 STARBUCKS**  
3373 Port Chicago Hwy  
Concord, CA
- 6 CHASE BANK**  
2097 Salvio St  
Concord, CA