

HOOVER BUSINESS PARK

12661 Hoover Street Stanton, CA 90680



Available SF
521-3,600 SF

Renovated
2022

Clear Height
16'-20'

Location
STANTON, CA



- Small-bay industrial park within central Orange County
- Warehouse suites with grade-level loading and office buildouts
- Efficient layouts designed to support operational flexibility

FOR MORE INFORMATION

Lori McAmis
Leasing Manager
BKM Management Company
P. 949.335.5826
E. LMCAMIS@BKMMGMT.COM

HOOVER BUSINESS PARK

12661 Hoover Street Stanton, CA 90680



LEGEND

- ▲ DOCK HIGH DOORS
- GRADE LEVEL DOORS

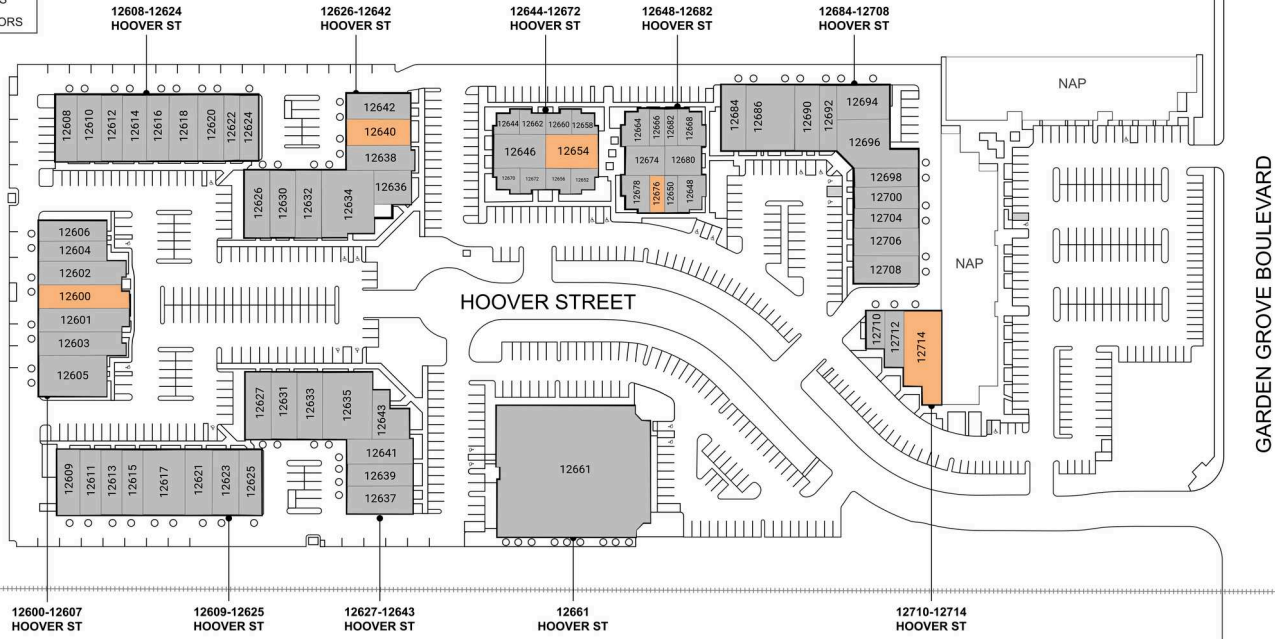

● AVAILABLE ● OCCUPIED

CURRENT AVAILABILITIES

BUILDING	SUITE	TOTAL SF	OFFICE SF	OFFICE %	TYPE	CLEAR HT	GL	DL
A	12600	3,394	0	0%	IND	N/A	N/A	N/A
D	12640	1,540	0	0%	IND	N/A	N/A	N/A
F	12654	521	0	0%	OFF	N/A	N/A	N/A
G	12676	937	0	0%	OFF	N/A	N/A	N/A
J	12714	3,600	0	0%	IND	N/A	N/A	N/A

HOOVER BUSINESS PARK

12661 Hoover Street Stanton, CA 90680



HOOVER BUSINESS PARK

12661 Hoover Street Stanton, CA 90680

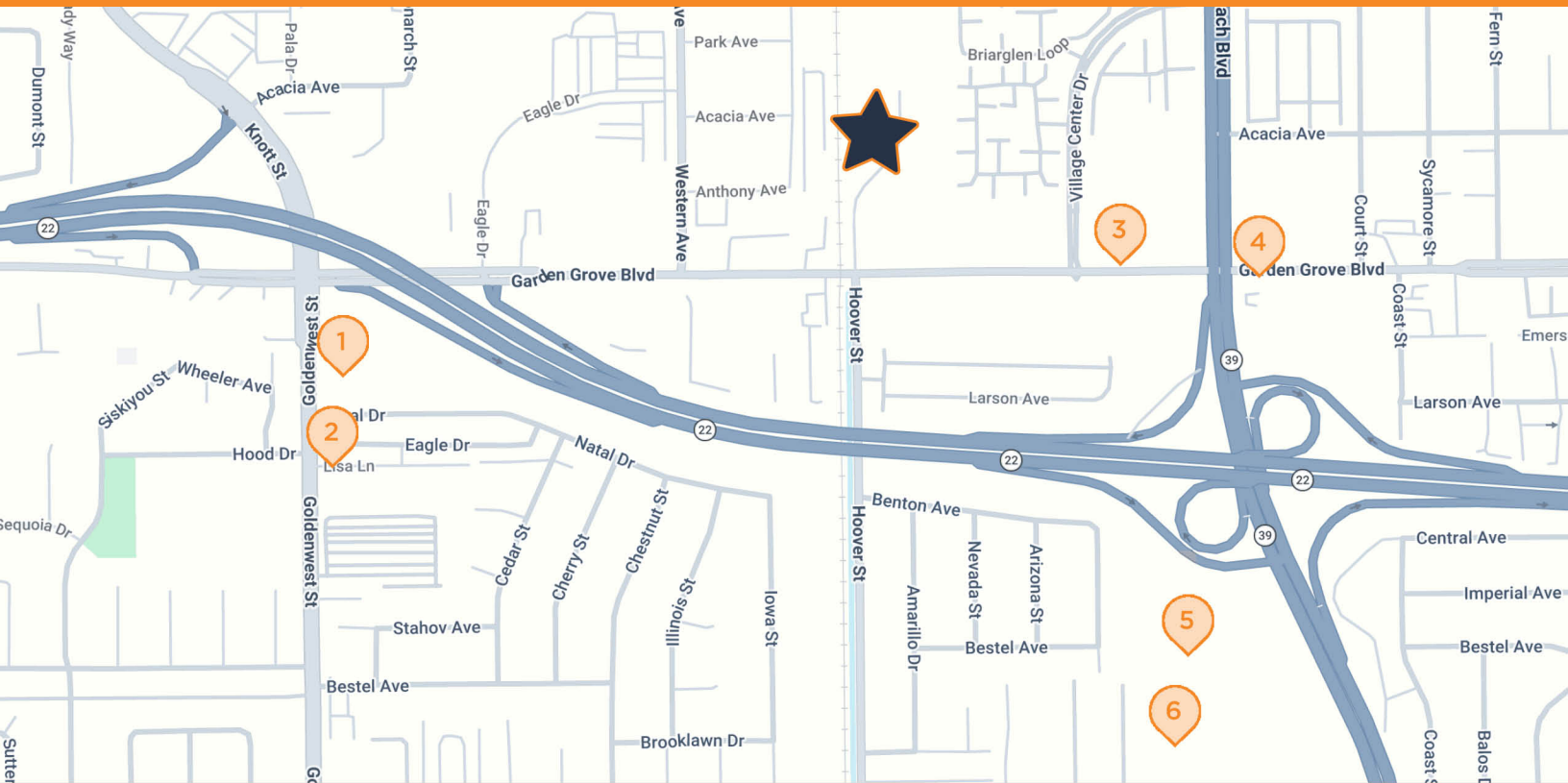

HOOVER BUSINESS PARK

12661 Hoover Street, Stanton, CA 90680

- | | | | |
|----------|--|----------|---|
| 1 | MOTEL 6
13100 Goldenwest St, Westminster, CA | 4 | STARBUCKS
12950 Beach Blvd, Stanton, CA |
| 2 | ARCO
13142 Goldenwest St, Westminster, CA | 5 | COSTCO
13225 Beach Blvd, Westminster, CA |
| 3 | THE UPS STORE
7927 Garden Grove Blvd, Garden Grove, CA | 6 | WALMART
13331 Beach Blvd, Westminster, CA |