

JUPITER BUSINESS PARK

1111 Jupiter Road Plano, TX 75074



<#



Available SF
48-6,518 SF

Renovated
2022

Clear Height
16'-20'

Location
PLANO, TX



FOR MORE INFORMATION

Henry Landwermeyer

Leasing Manager

BKM Management

P. 713.444.5944

E. [HLANDWERMEYER@BKMMGMT.COM](mailto:H.LANDWERMEYER@BKMMGMT.COM)

- Multi-tenant industrial park serving the Plano and North Dallas markets
- Warehouse suites with loading access and efficient layouts
- Convenient access to US-75 and regional transportation routes

JUPITER BUSINESS PARK

1111 Jupiter Road Plano, TX 75074



LEGEND

- ▲ DOCK HIGH DOORS
- GRADE LEVEL DOORS

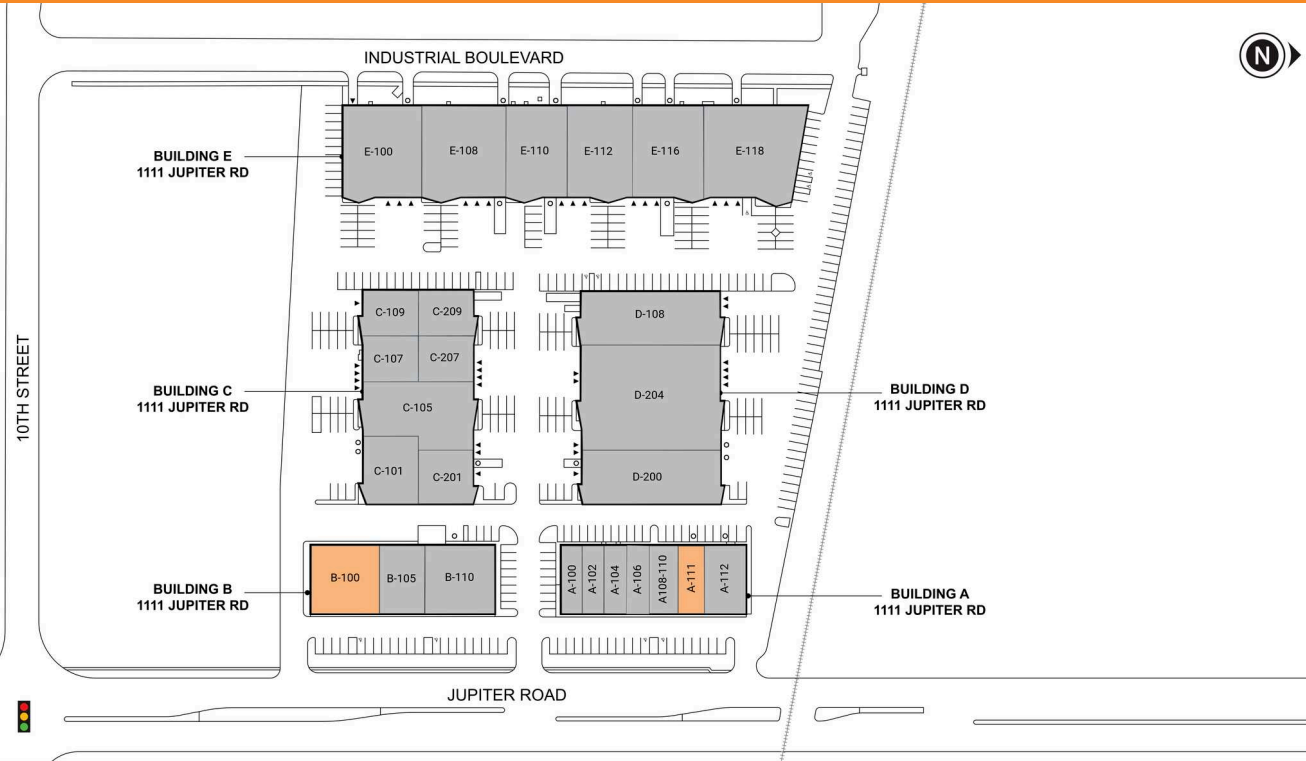

● AVAILABLE ● OCCUPIED

CURRENT AVAILABILITIES

BUILDING	SUITE	TOTAL SF	OFFICE SF	OFFICE %	TYPE	CLEAR HT	GL	DL
N/a	A-111	48	N/A	N/A	N/A	N/A	N/A	N/A
N/a	B-100	6,518	N/A	N/A	N/A	N/A	N/A	N/A

JUPITER BUSINESS PARK

1111 Jupiter Road Plano, TX 75074



JUPITER BUSINESS PARK

1111 Jupiter Road Plano, TX 75074

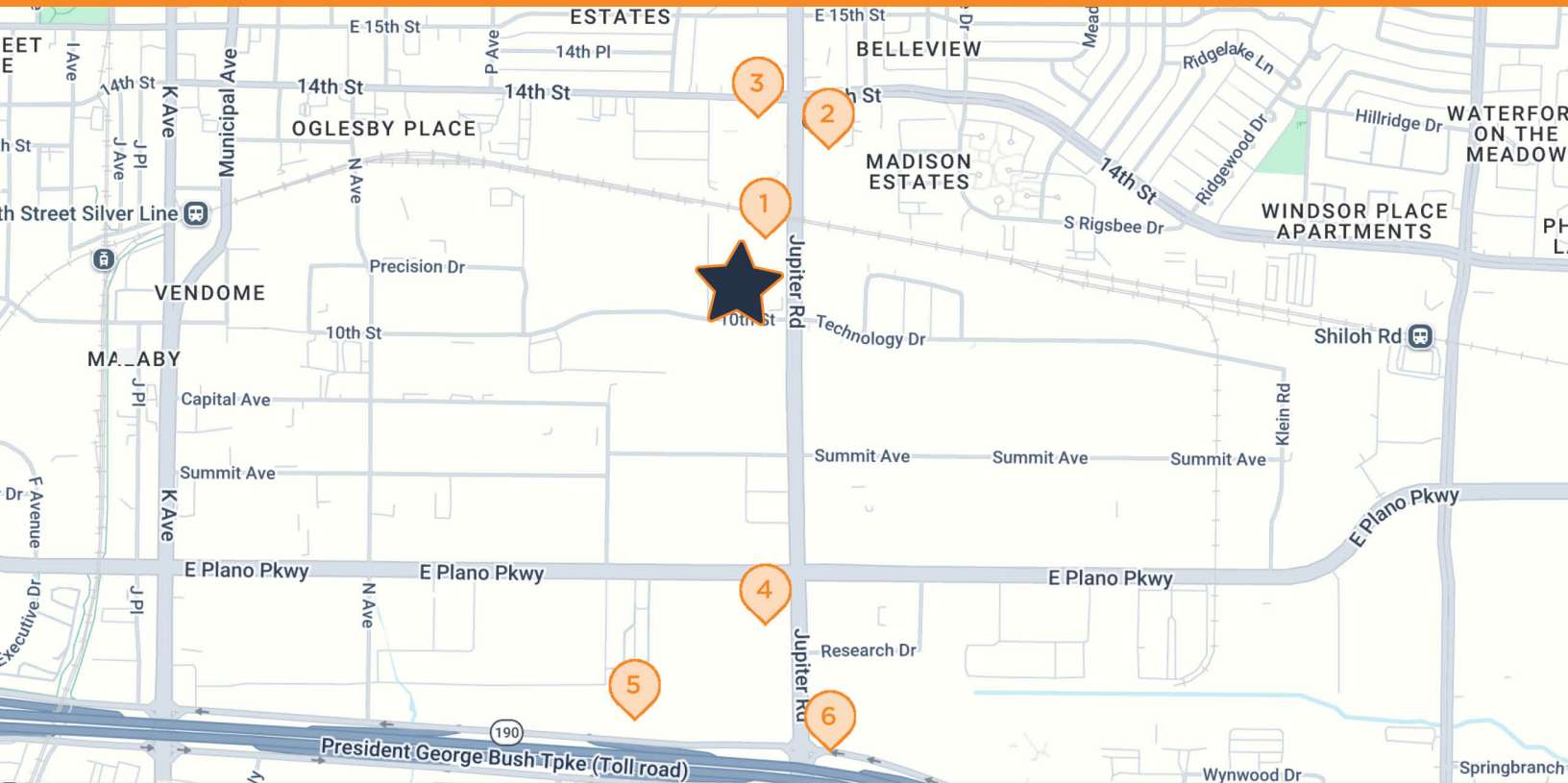

JUPITER BUSINESS PARK

1111 Jupiter Road, Plano, TX 75074

- | | | | |
|----------|--|----------|--|
| 1 | JIMMY JOHN'S
1201 Jupiter Rd, Plano, TX | 4 | WELLS FARGO BANK
2400 E Plano Pkwy, Plano, TX |
| 2 | VALERO GAS STATION
2500 14th St, Plano, TX | 5 | HOLIDAY INN EXPRESS & SUITES
2001 E President George Bush Hwy, Plano, TX |
| 3 | KFC
2301 14th St, Plano, TX | 6 | MCDONALD'S
400 Jupiter Rd, Plano, TX |