

# JUPITER BUSINESS PARK

1111 Jupiter Road Plano, TX 75074



Available SF  
**48-6,518 SF**

Renovated  
**2022**

Clear Height  
**16'-20'**

Location  
**PLANO, TX**



## FOR MORE INFORMATION

**Henry Landwermeyer**

Leasing Manager

BKM Management

P. 713.444.5944

E. [HLANDWERMEYER@BKMMGMT.COM](mailto:H.LANDWERMEYER@BKMMGMT.COM)

- Multi-tenant industrial park serving the Plano and North Dallas markets
- Warehouse suites with loading access and efficient layouts
- Convenient access to US-75 and regional transportation routes

# JUPITER BUSINESS PARK

1111 Jupiter Road Plano, TX 75074



**LEGEND**

- ▲ DOCK HIGH DOORS
- GRADE LEVEL DOORS

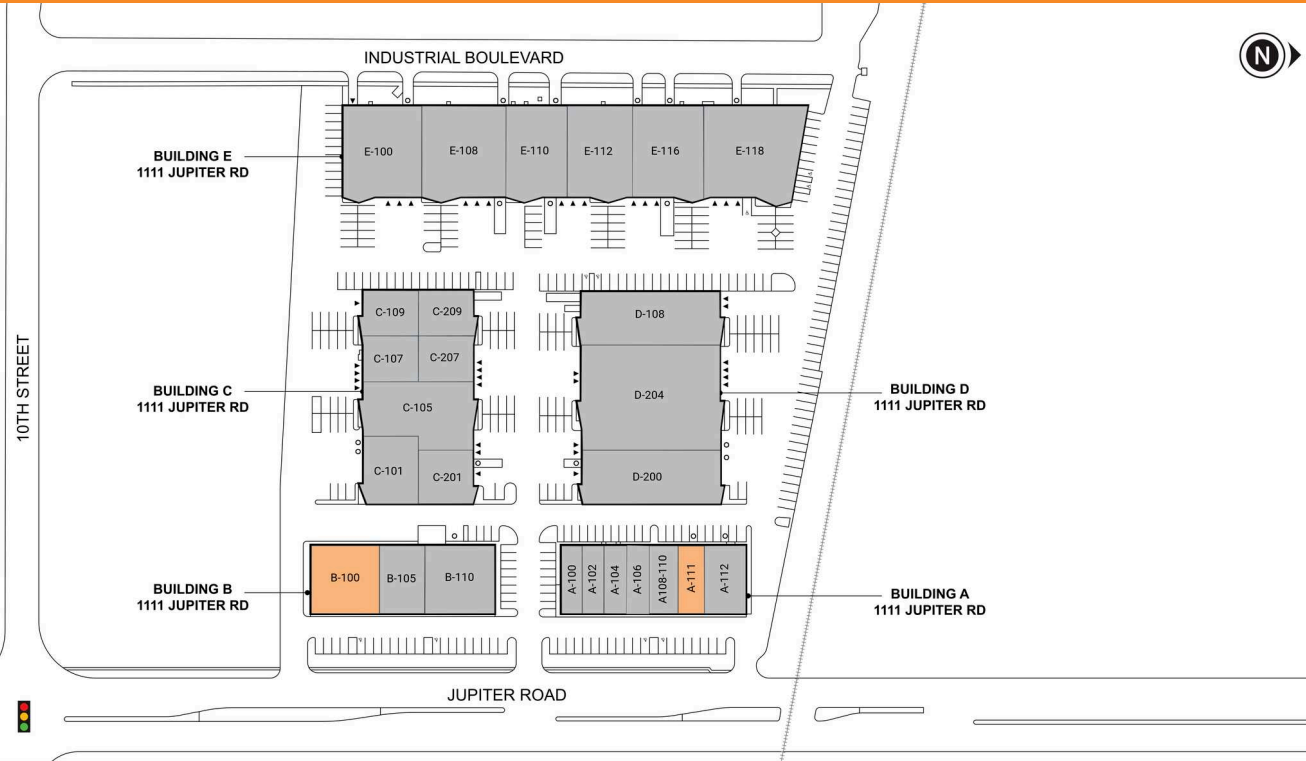

● AVAILABLE ● OCCUPIED

## CURRENT AVAILABILITIES

BUILDING	SUITE	TOTAL SF	OFFICE SF	OFFICE %	TYPE	CLEAR HT	GL	DL
N/a	A-111	48	N/A	N/A	N/A	N/A	N/A	N/A
N/a	B-100	6,518	N/A	N/A	N/A	N/A	N/A	N/A

# JUPITER BUSINESS PARK

1111 Jupiter Road Plano, TX 75074



# JUPITER BUSINESS PARK

1111 Jupiter Road Plano, TX 75074

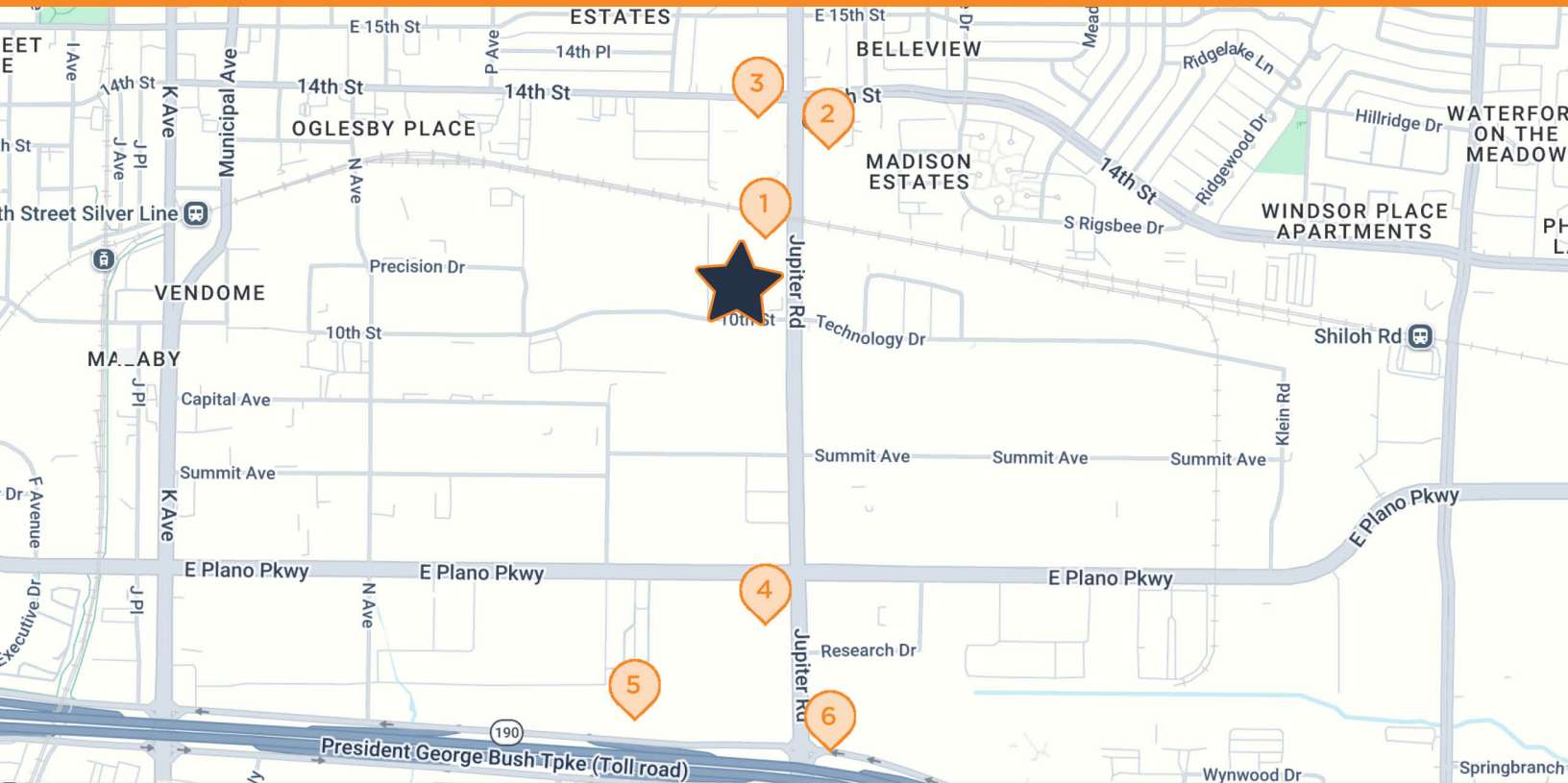

## JUPITER BUSINESS PARK

1111 Jupiter Road, Plano, TX 75074

- |   |   |
|---|---|
| <b>1</b> <b>JIMMY JOHN'S</b><br>1201 Jupiter Rd, Plano, TX    | <b>4</b> <b>WELLS FARGO BANK</b><br>2400 E Plano Pkwy, Plano, TX                                |
| <b>2</b> <b>VALERO GAS STATION</b><br>2500 14th St, Plano, TX | <b>5</b> <b>HOLIDAY INN EXPRESS &amp; SUITES</b><br>2001 E President George Bush Hwy, Plano, TX |
| <b>3</b> <b>KFC</b><br>2301 14th St, Plano, TX                | <b>6</b> <b>MCDONALD'S</b><br>400 Jupiter Rd, Plano, TX   |