

HARBOR WARNER BUSINESS PARK

2720 S. Harbor Santa Ana, CA 92704



Available SF
667-2,357 SF

Renovated
2022

Clear Height
16'-20'

Location
SANTA ANA, CA



- Industrial property with strong frontage along Harbor Boulevard
- Warehouse suites with loading access and office areas
- Easy access to the 405 and 55 freeways

FOR MORE INFORMATION

Nelson Simons

Leasing Manager
BKM Management Company
P. 949.877.7140
E. NSIMONS@BKMMGMT.COM

Skyler Serrano

Leasing Agent
Lee & Associates
P. 949.790.3180
E. SERRANO@LEEIRVINE.COM

Jason Helmick

Leasing Agent
Lee & Associates
P. 949.790.3119
E. JHELMICK@LEEIRVINE.COM

HARBOR WARNER BUSINESS PARK

2720 S. Harbor Santa Ana, CA 92704



LEGEND

- ▲ DOCK HIGH DOORS
- GRADE LEVEL DOORS

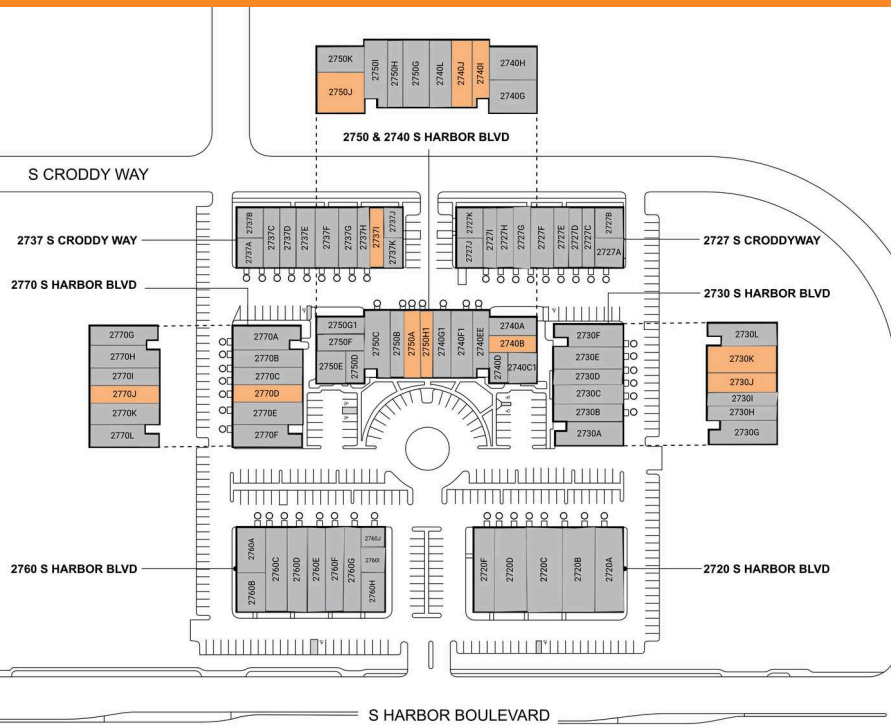

● AVAILABLE ● OCCUPIED

CURRENT AVAILABILITIES

BUILDING	SUITE	TOTAL SF	OFFICE SF	OFFICE %	TYPE	CLEAR HT	GL	DL
N/a	2730J	N/A	N/A	N/A	N/A	N/A	N/A	N/A
N/a	2730K	N/A	N/A	N/A	N/A	N/A	N/A	N/A
D	2737I	1,460	0	0%	IND	N/A	N/A	N/A
E	2740B	1,412	0	0%	OFF	N/A	N/A	N/A
E	2740I	667	0	0%	OFF	N/A	N/A	N/A
E	2740J	2,357	0	0%	OFF	N/A	N/A	N/A
F	2750A	1,942	0	0%	IND	N/A	N/A	N/A
F	2750H1	1,942	0	0%	IND	N/A	N/A	N/A
F	2750J	1,179	0	0%	OFF	N/A	N/A	N/A
H	2770D	1,826	0	0%	IND	N/A	N/A	N/A
N/a	2770D	1,826	N/A	N/A	N/A	N/A	N/A	N/A
H	2770J	782	0	0%	OFF	N/A	N/A	N/A
N/a	2770J	782	N/A	N/A	N/A	N/A	N/A	N/A

HARBOR WARNER BUSINESS PARK

2720 S. Harbor Santa Ana, CA 92704



HARBOR WARNER BUSINESS PARK

2720 S. Harbor Santa Ana, CA 92704

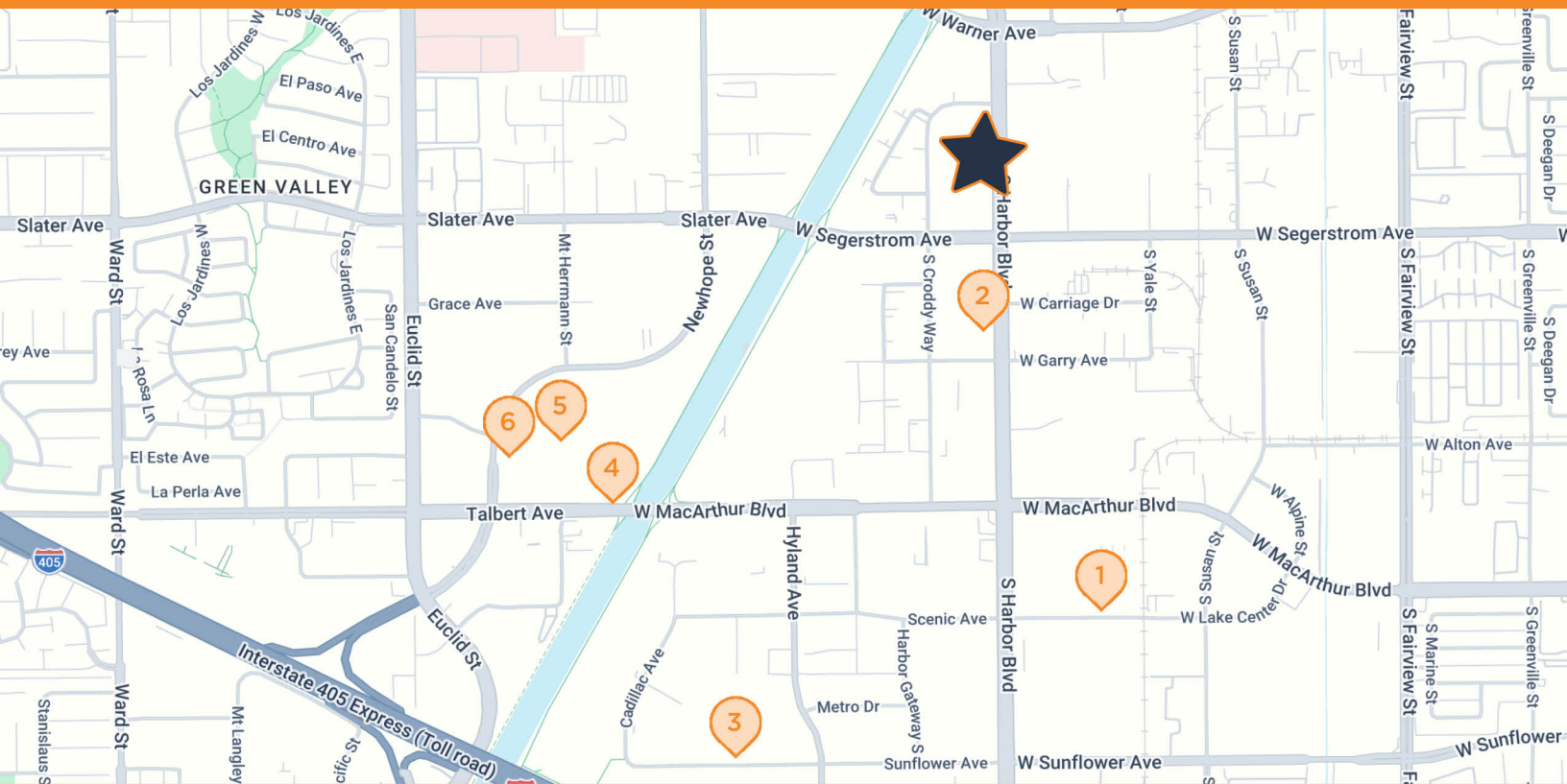

HARBOR WARNER BUSINESS PARK 2720 S. Harbor, Santa Ana, CA 92704

- | | | | |
|----------|---|----------|---|
| 1 | THE HOME DEPOT
3500 W MacArthur Blvd, Santa Ana, CA | 4 | COSTCO
17900 Newhope St, Fountain Valley, CA |
| 2 | COURTYARD BY MARRIOTT
3002 S Harbor Blvd, Santa Ana, CA | 5 | THE UPS STORE
17870 Newhope St, Fountain Valley, CA |
| 3 | FEDEX SHIP CENTER
1650 Sunflower Ave, Costa Mesa, CA | 6 | STARBUCKS
17850 Newhope St, Fountain Valley, CA |