

# SAVI RANCH INDUSTRIAL PARK

22601-22659 Old Canal Road Yorba Linda, CA 92887



Available SF  
**NO AVAILABILITIES**

Renovated  
**2022**

Clear Height  
**16'-20'**

Location  
**YORBA LINDA, CA**



## FOR MORE INFORMATION

### Giselle Elsahragty

Leasing Manager  
BKM Management Company  
P. 949.807.3718  
E. GELSAHRAGTY@BKMMGMT.COM

### Hayden Socci

Leasing Agent  
Voit Co.  
P. 714.935.2379  
E. HSOCCI@VOITCO.COM

- Multi-tenant industrial park featuring small-bay warehouse suites
- Ground-level loading and efficient building configurations
- Convenient access to the 91 freeway and regional transportation routes

# SAVI RANCH INDUSTRIAL PARK

22601-22659 Old Canal Road Yorba Linda, CA 92887



**LEGEND**

- ▲ DOCK HIGH DOORS
- GRADE LEVEL DOORS

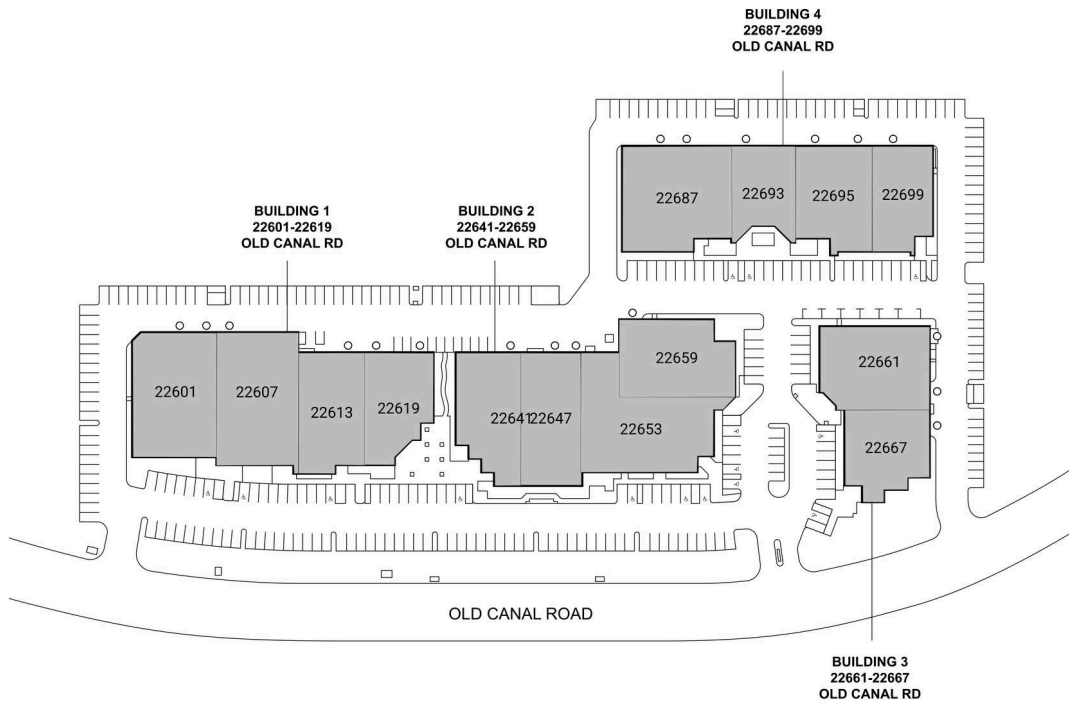

● AVAILABLE ● OCCUPIED

## CURRENT AVAILABILITIES

BUILDING	SUITE	TOTAL SF	OFFICE SF	OFFICE %	TYPE	CLEAR HT	GL	DL
----------	-------	----------	-----------	----------	------	----------	----	----

# SAVI RANCH INDUSTRIAL PARK

22601-22659 Old Canal Road Yorba Linda, CA 92887

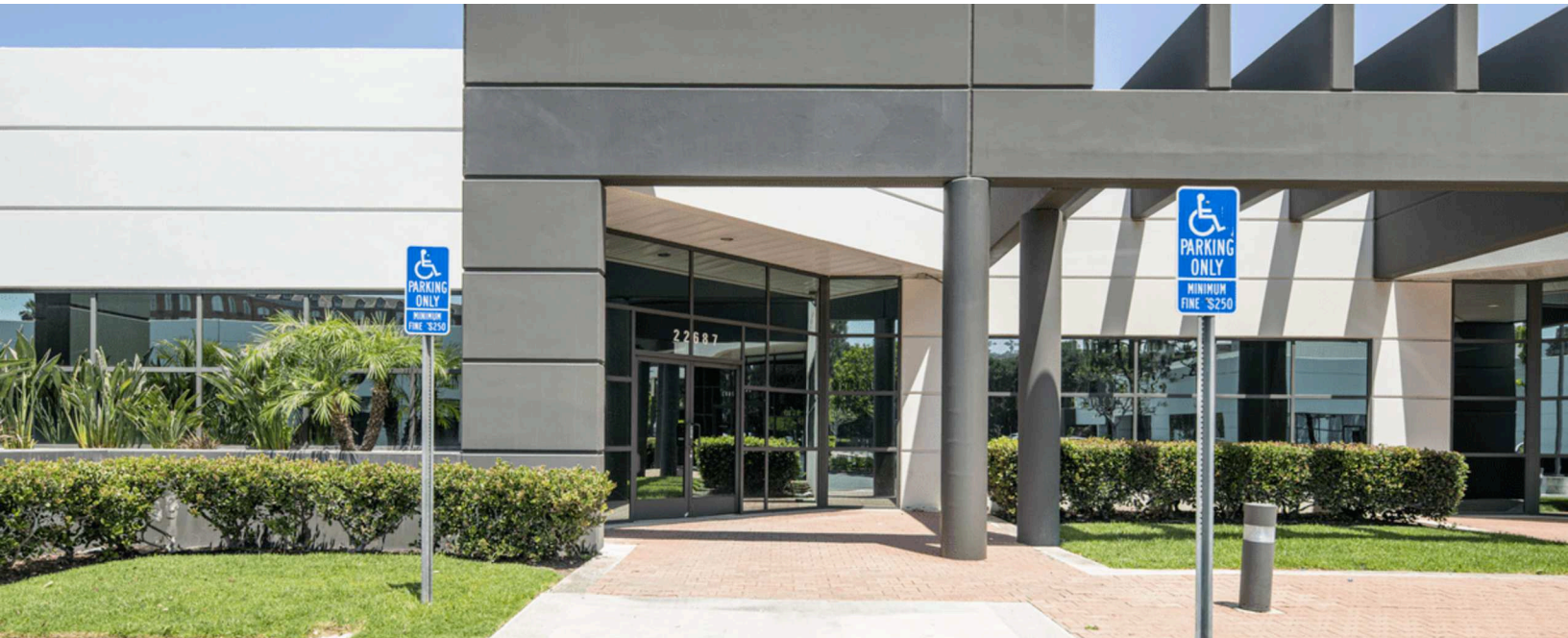

# SAVI RANCH INDUSTRIAL PARK

22601-22659 Old Canal Road Yorba Linda, CA 92887

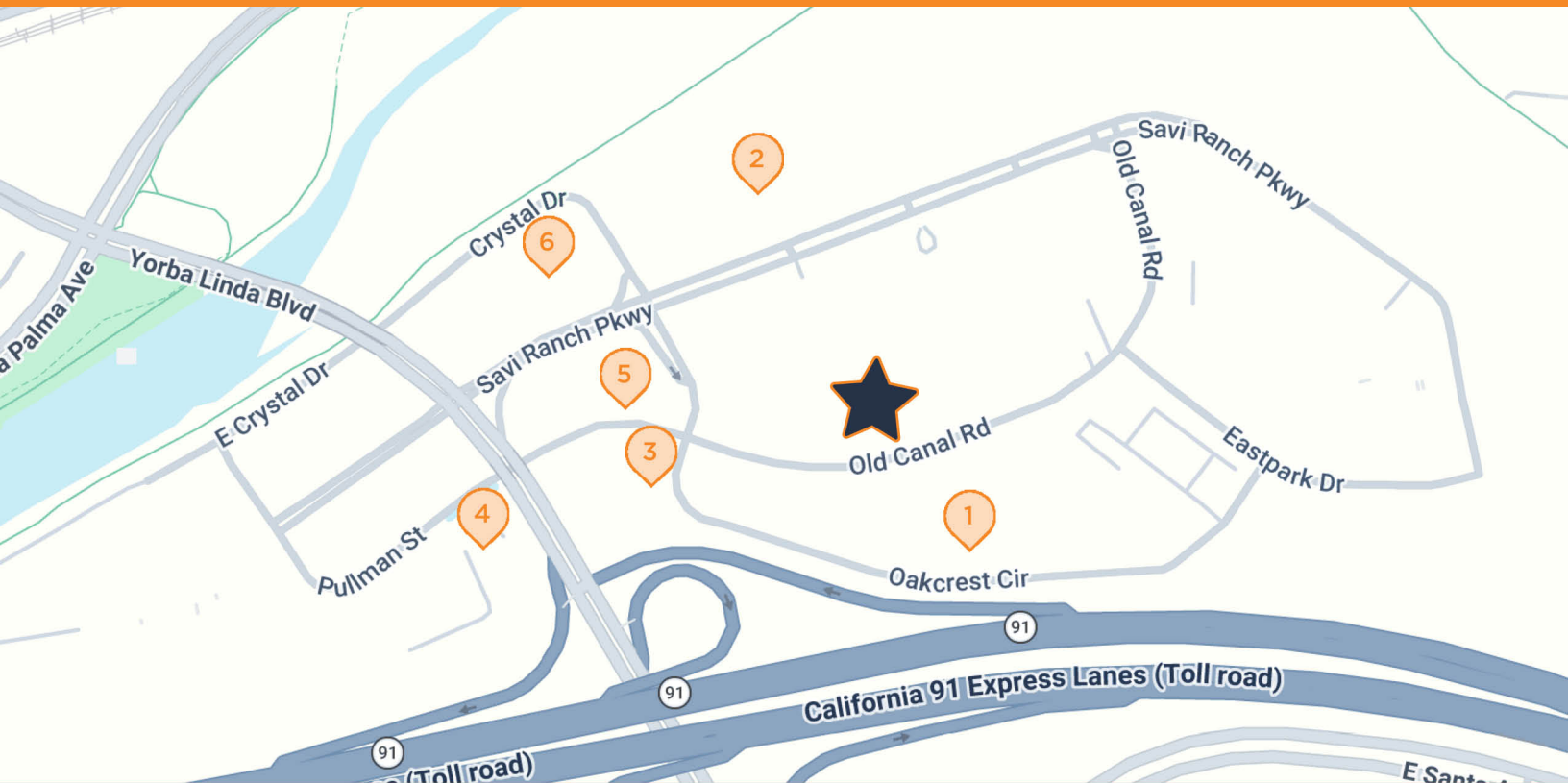

## SAVI RANCH INDUSTRIAL PARK

22601-22659 Old Canal Road, Yorba Linda, CA 92887

- |          |  |          |  |
|----------|--|----------|--|
| <b>1</b> | <b>AYRES SUITES</b><br>22677 Oakcrest Cir, Yorba Linda, CA | <b>4</b> | <b>76 GAS STATION</b><br>985 N Weir Canyon Rd, Anaheim, CA           |
| <b>2</b> | <b>COSTCO</b><br>22633 Savi Ranch Pkwy, Yorba Linda, CA    | <b>5</b> | <b>SPROUTS FARMERS MARKET</b><br>22401 Old Canal Rd, Yorba Linda, CA |
| <b>3</b> | <b>CHICK-FIL-A</b><br>22450 Old Canal Rd, Yorba Linda, CA  | <b>6</b> | <b>STAPLES</b><br>5511 Mirage St, Yorba Linda, CA                    |