

TIGARD BUSINESS PARK

11844 SW PACIFIC HWY • TIGARD, OR 97223



- 7-building industrial business center
- Conveniently located next to Oregon Route 217, Oregon Route 99W, and near I-5
- 256,084 Square Feet

Property Summary

AVAILABLE SF	3,200-7,039 SF
BUILDING SIZE	258,879 SF
MARKET	Tigard

For more information, please contact:

MONICA AYDELOTTE
PROPERTY MANAGER
P. 206.487.7043
E. MAYDELOTTE@BKMMGMT.COM

TIGARD BUSINESS PARK

11844 SW PACIFIC HWY • TIGARD, OR 97223



LEGEND

- ▲ DOCK HIGH DOORS
- GRADE LEVEL DOORS

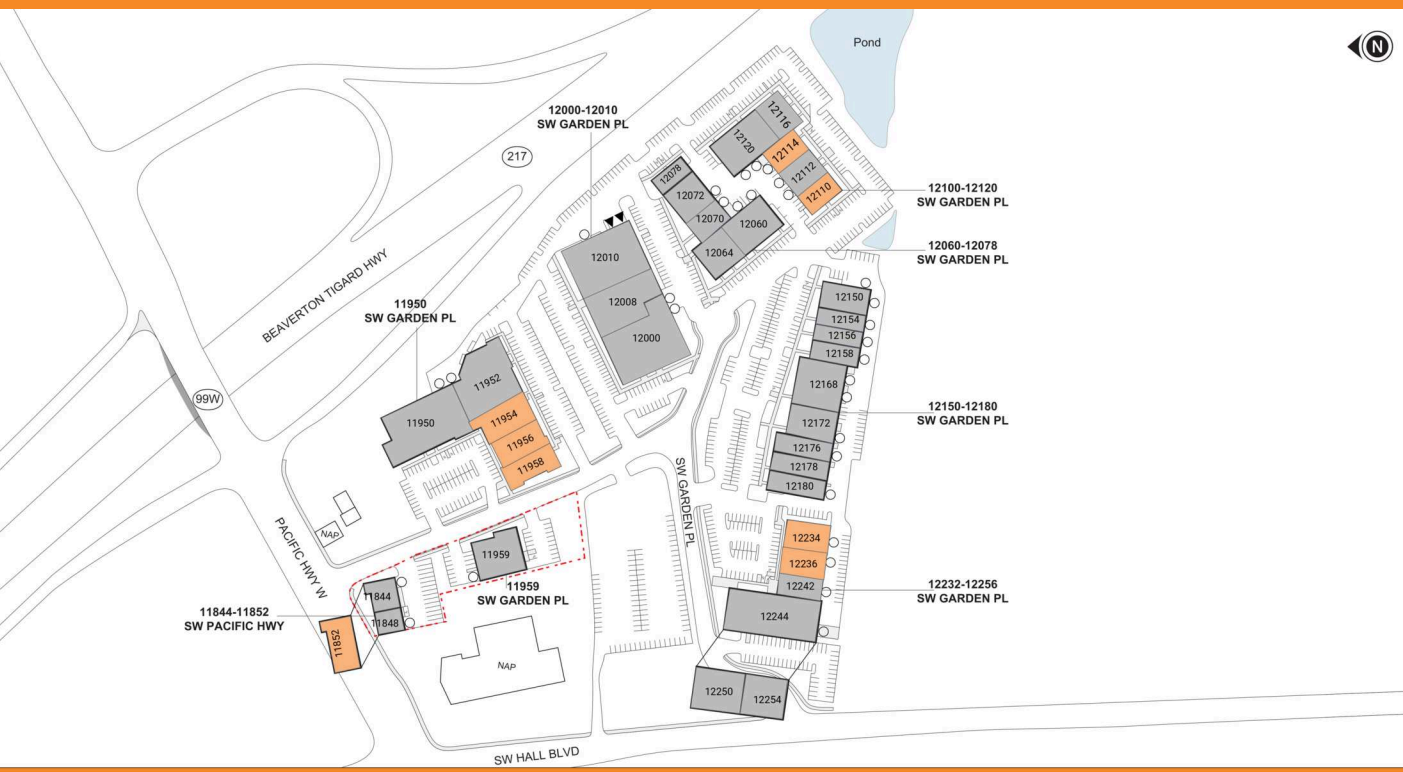

■ AVAILABLE ■ OCCUPIED

Current Availabilities

BUILDING	SUITE	TOTAL SIZE	OFFICE SIZE	OFFICE %	TYPE	CLEAR HT	GL	DL	RATE
N/A	11852	4,873	0	0	N/A	0	0	0	N/A
N/A	11954	5,893	3,027	51	Industrial	15	1	1	N/A
N/A	11956	7,039	2,756	39	Industrial	15	1	1	N/A
N/A	11958	7,006	7,006	100	Office	0	0	0	N/A
N/A	12110	3,200	0	0	N/A	0	0	0	N/A
N/A	12114	4,138	2,069	50	Industrial	15	1	0	N/A
N/A	12234	5,428	2,194	40	Industrial	15	1	0	N/A
N/A	12236	5,106	1,256	25	Industrial	15	1	0	N/A

TIGARD BUSINESS PARK

11844 SW PACIFIC HWY • TIGARD, OR 97223



NEARBY AMENITIES

TIGARD BUSINESS PARK

11844 SW PACIFIC HWY • TIGARD, OR 97223

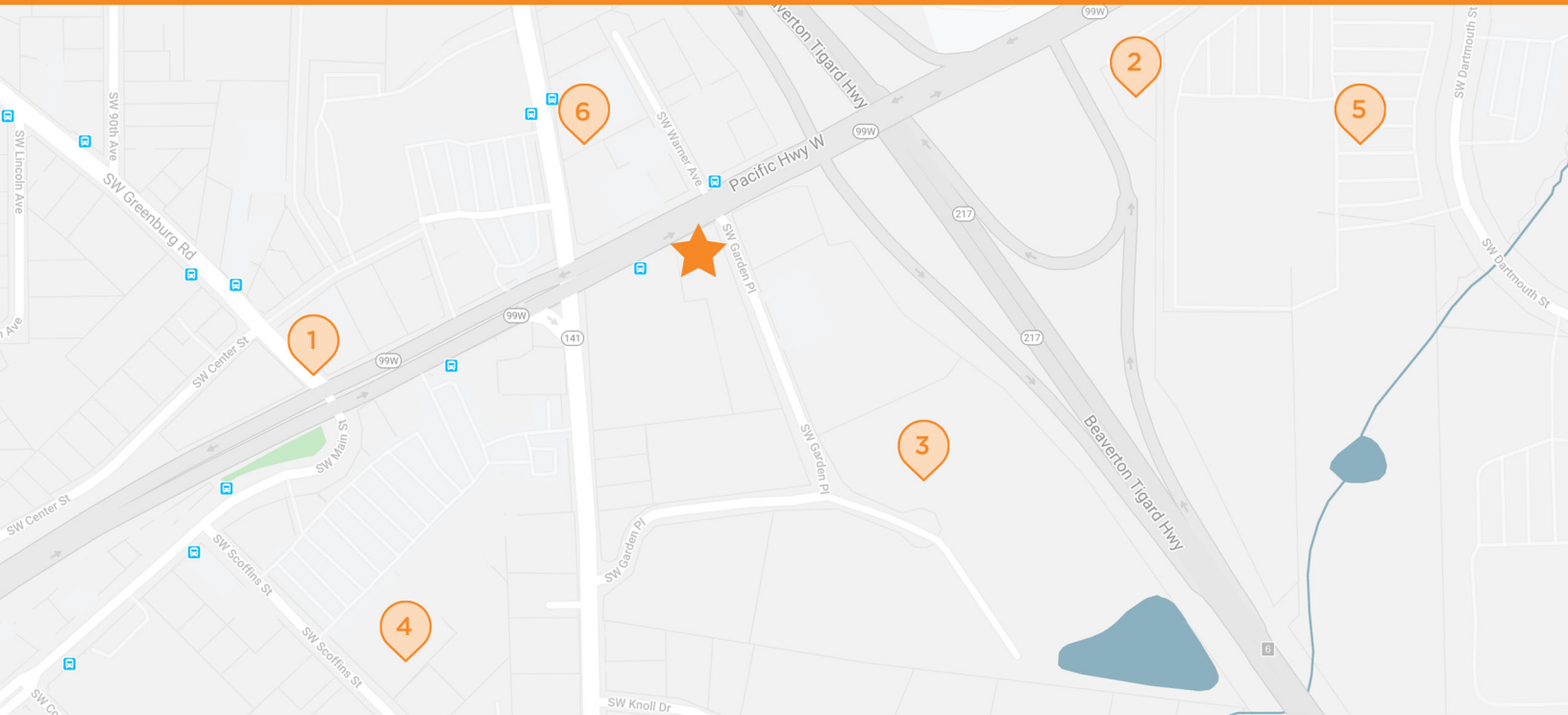

TIGARD BUSINESS PARK

11844-11852 SW Pacific Hwy.; 11950-12256 SW Garden Pl., Tigard, OR 97223



BANK OF AMERICA

11999 SW Pacific Hwy
Tigard, OR



DUTCH BROS COFFEE

11744 SW Pacific Hwy
Tigard, OR



SKYHOOK NINJA FITNESS

12008 SW Garden Pl
Tigard, OR



RITE AID PHARMACY

12080 SW Main St
Tigard, OR



COSTCO

7850 SW Dartmouth St
Tigard, OR



WELLS FARGO BANK

11760 SW Hall Blvd
Tigard, OR