

BROADWOOD BUSINESS PARK

2452 W BIRCHWOOD AVE • MESA, AZ 85202



- 11-building industrial center
- 156,197 total square feet
- Centrally located: Under fifteen minutes to Chandler, Gilbert, Tempe, and Scottsdale. 10 minutes to Mesa downtown, 14 minutes to Sky Harbor Airport
- Close proximity to AZ-101, AZ-202, & US-60 Freeways
- Parking Ratio: 2.02/1,000 SF

Property Summary

AVAILABLE SF	SF
BUILDING SIZE	156,154 SF
MARKET	Mesa

For more information, please contact:

RICKY BORANE

LEASING MANAGER
BKM MANAGEMENT COMPANY
P. 602.362.0803
E. RBORANE@BKMMGMT.COM

GOLDEN ST. JOHN

LEASING AGENT
P. 602.222.5110
E. GOLDEN.STJOHN@COLLIERS.COM

BROADWOOD BUSINESS PARK

2452 W BIRCHWOOD AVE • MESA, AZ 85202

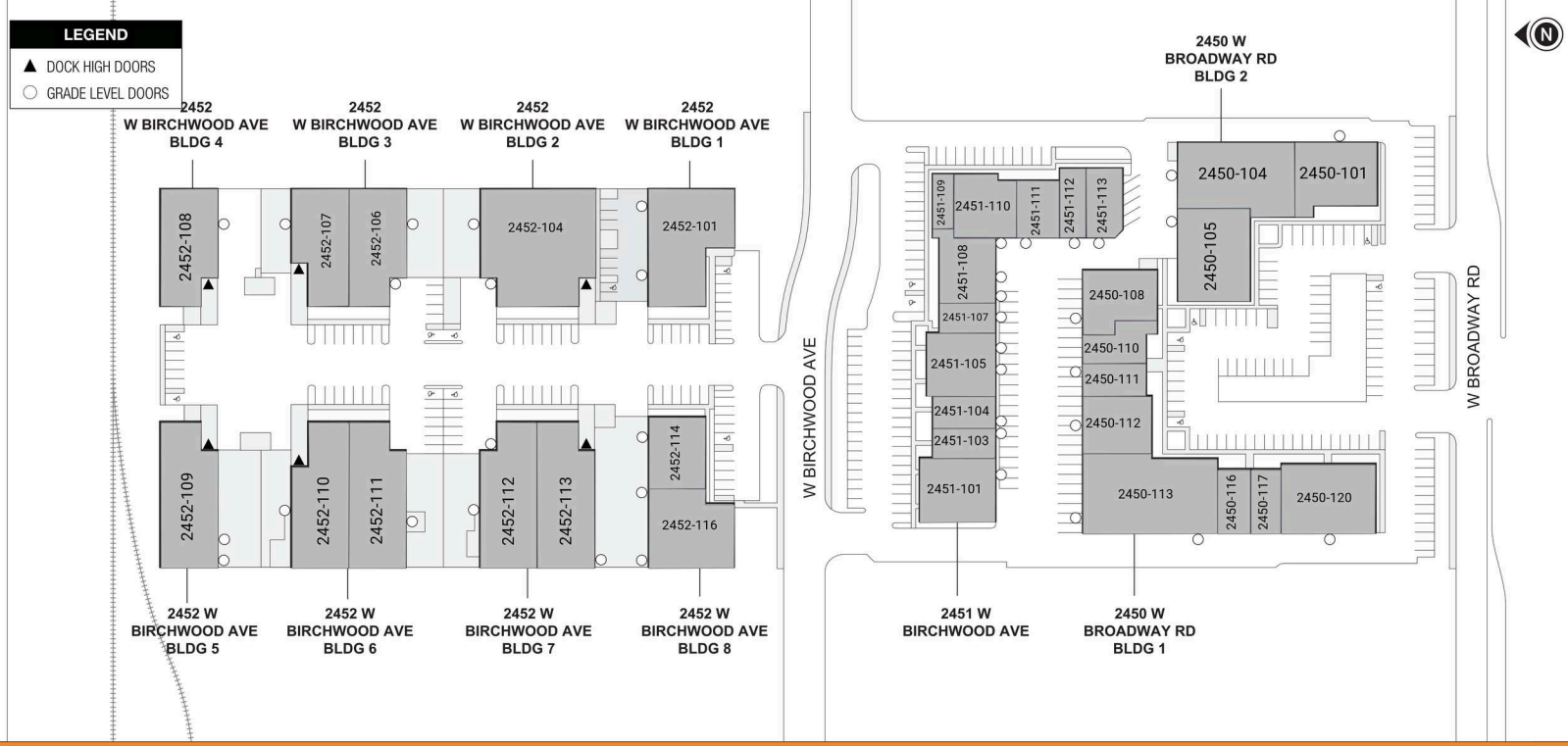

■ AVAILABLE ■ OCCUPIED

Current Availabilities

BUILDING	SUITE	TOTAL SIZE	OFFICE SIZE	OFFICE %	TYPE	CLEAR HT	GL	DL	RATE
----------	-------	------------	-------------	----------	------	----------	----	----	------

BROADWOOD BUSINESS PARK

2452 W BIRCHWOOD AVE • MESA, AZ 85202



NEARBY AMENITIES

BROADWOOD BUSINESS PARK

2452 W BIRCHWOOD AVE • MESA, AZ 85202

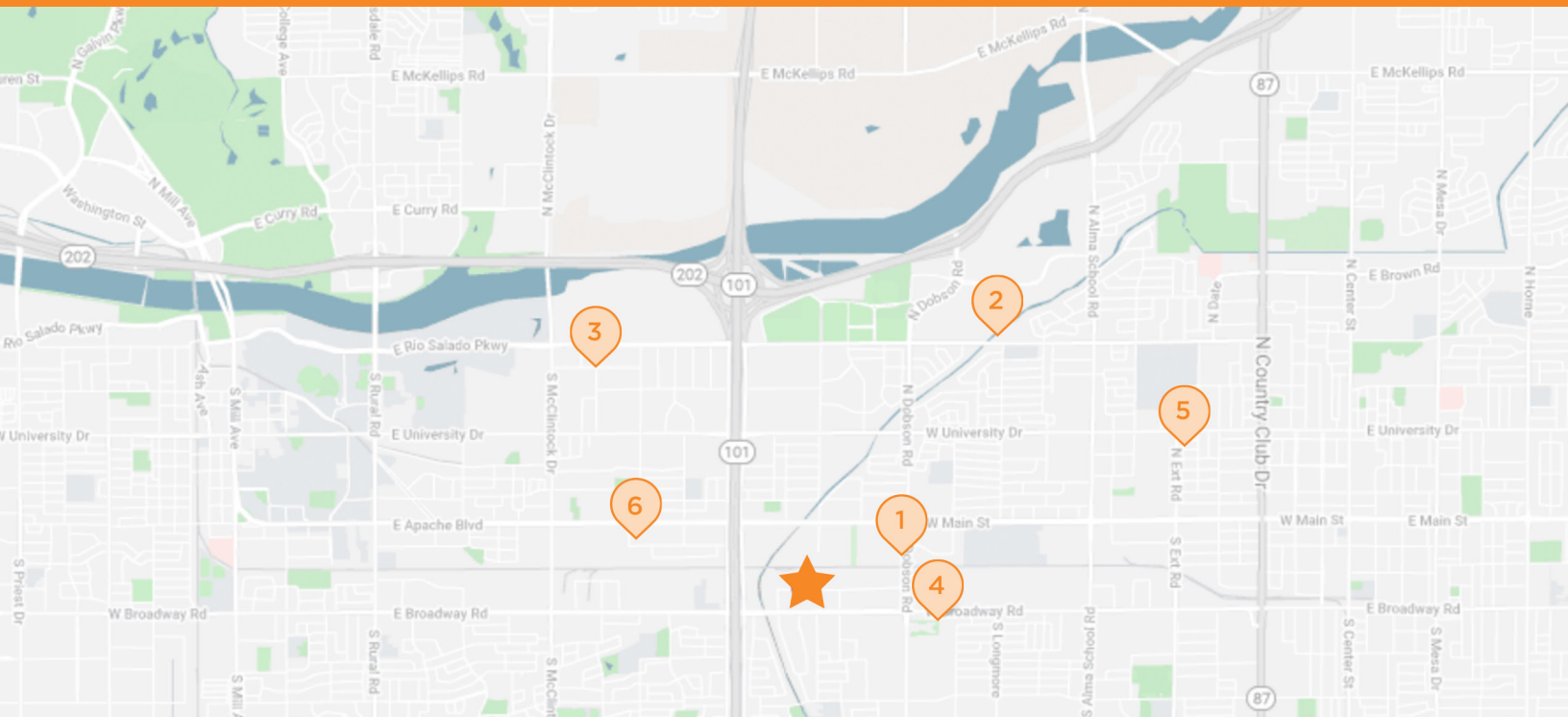

BROADWOOD BUSINESS PARK

2452, 2450, 2451 W. Birchwood Ave; 2450 W. Broadway Road, Mesa, AZ 85202



CHASE BANK

28 S Dobson Road
Mesa, AZ



WALMART

857 N Dobson Road
Mesa, AZ



TARGET

1800 E Rio Salado Pkwy
Mesa, AZ



KOREATOWN

1832 W Broadway Road
Mesa, AZ



FEDEX SHIPPING

746 W University Drive
Mesa, AZ



US POST OFFICE

1962 E Apache Blvd
Mesa, AZ